



HE 7Series 6Series
Product presentation
Product Management Platform Lifts

ThyssenKrupp Encasa



ThyssenKrupp

Table of contents

- Key technical data
- Benefits
- Applications
- Main components and options
- Required construction works and predispositions
- Installation and maintenance activities
- Marketing material

Key technical data

Key technical data

Table of contents

- Mechanics data

- Electric / Electronic data

- Technical specifications

- Cabin configurations and materials

- Cabin and shaft dimensions



Key technical data

Mechanics data

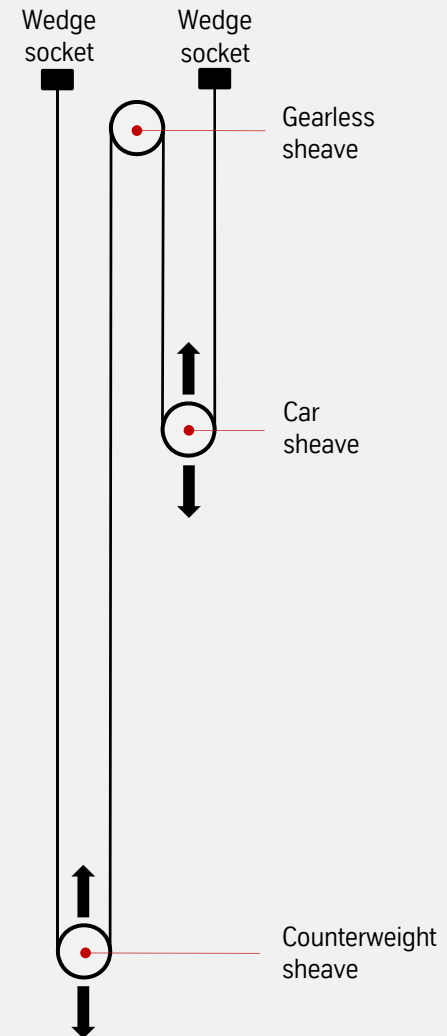
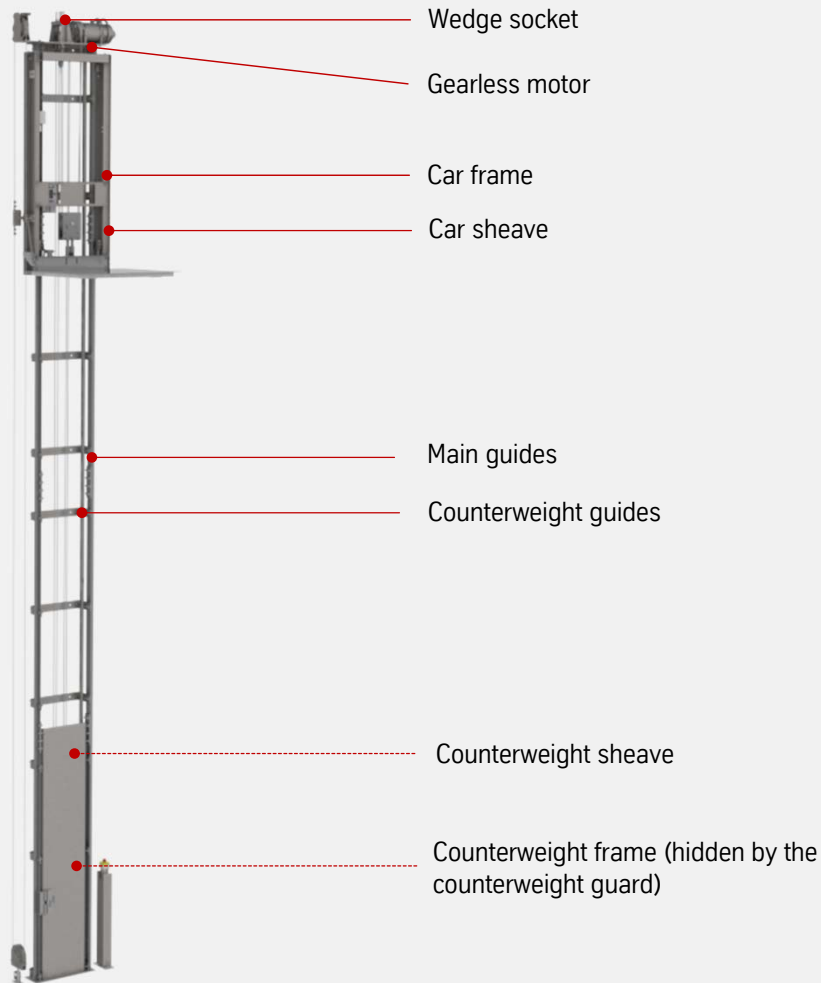

Key technical data

Mechanics data

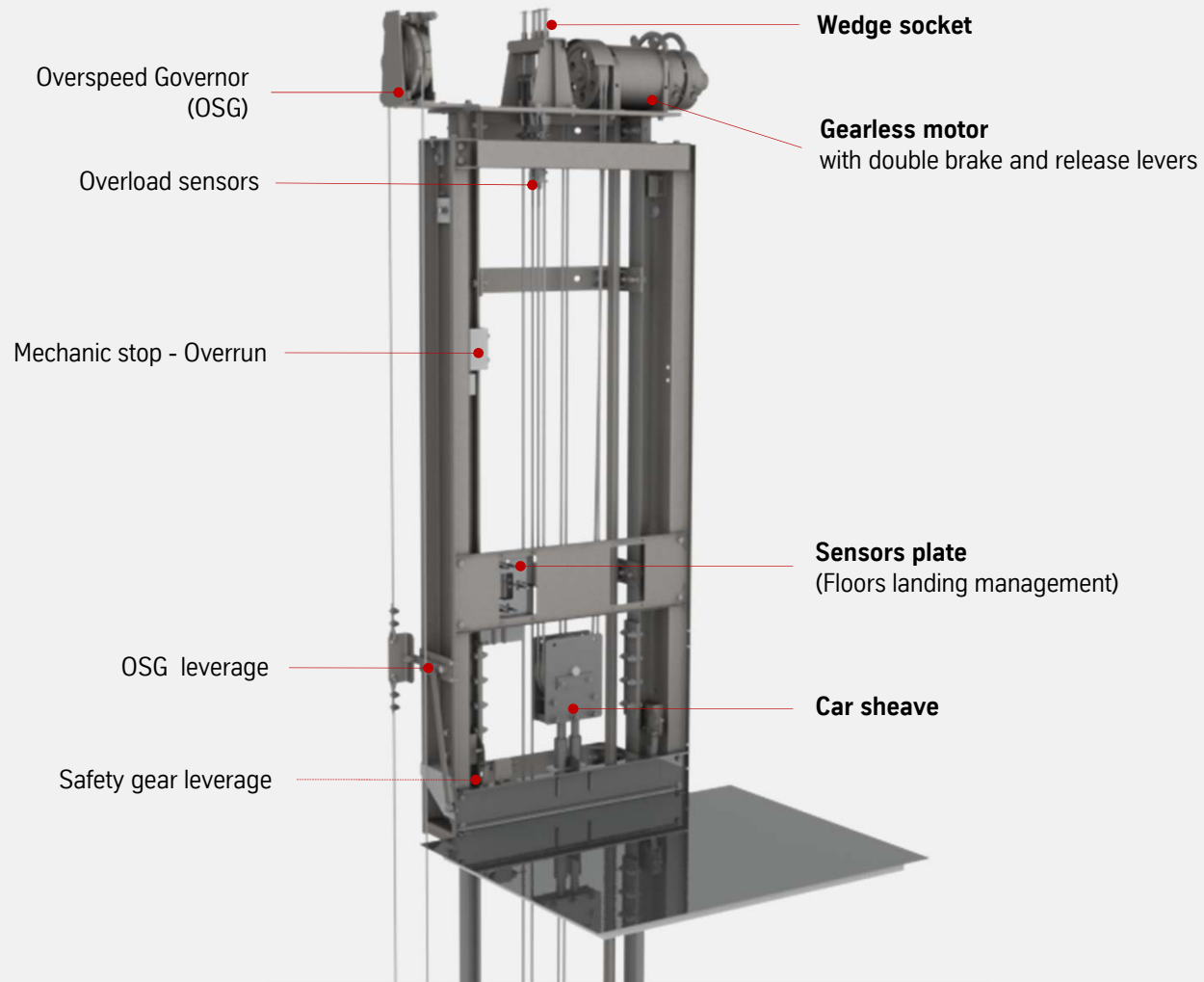

Key technical data

Mechanics data

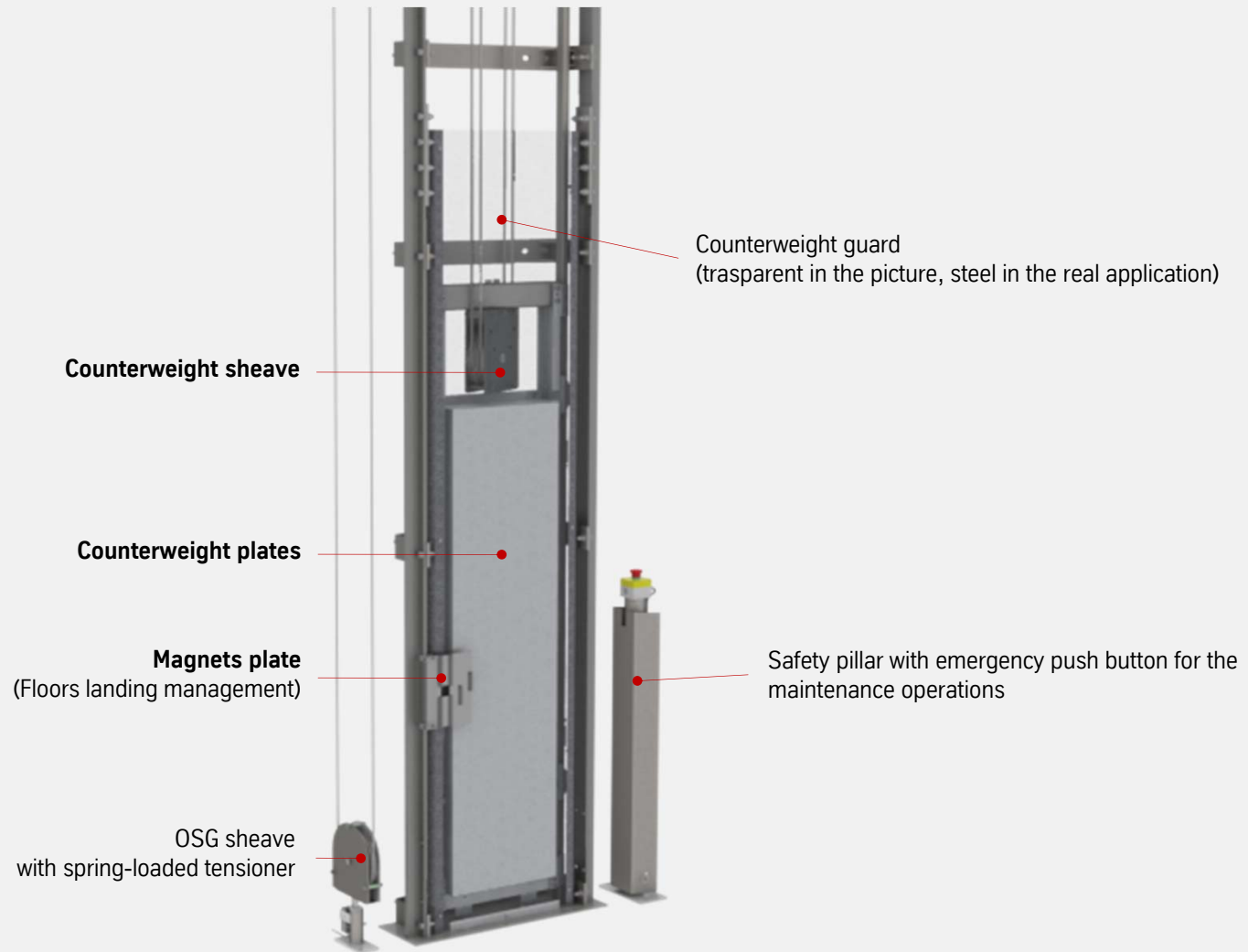

Key technical data

Mechanics data

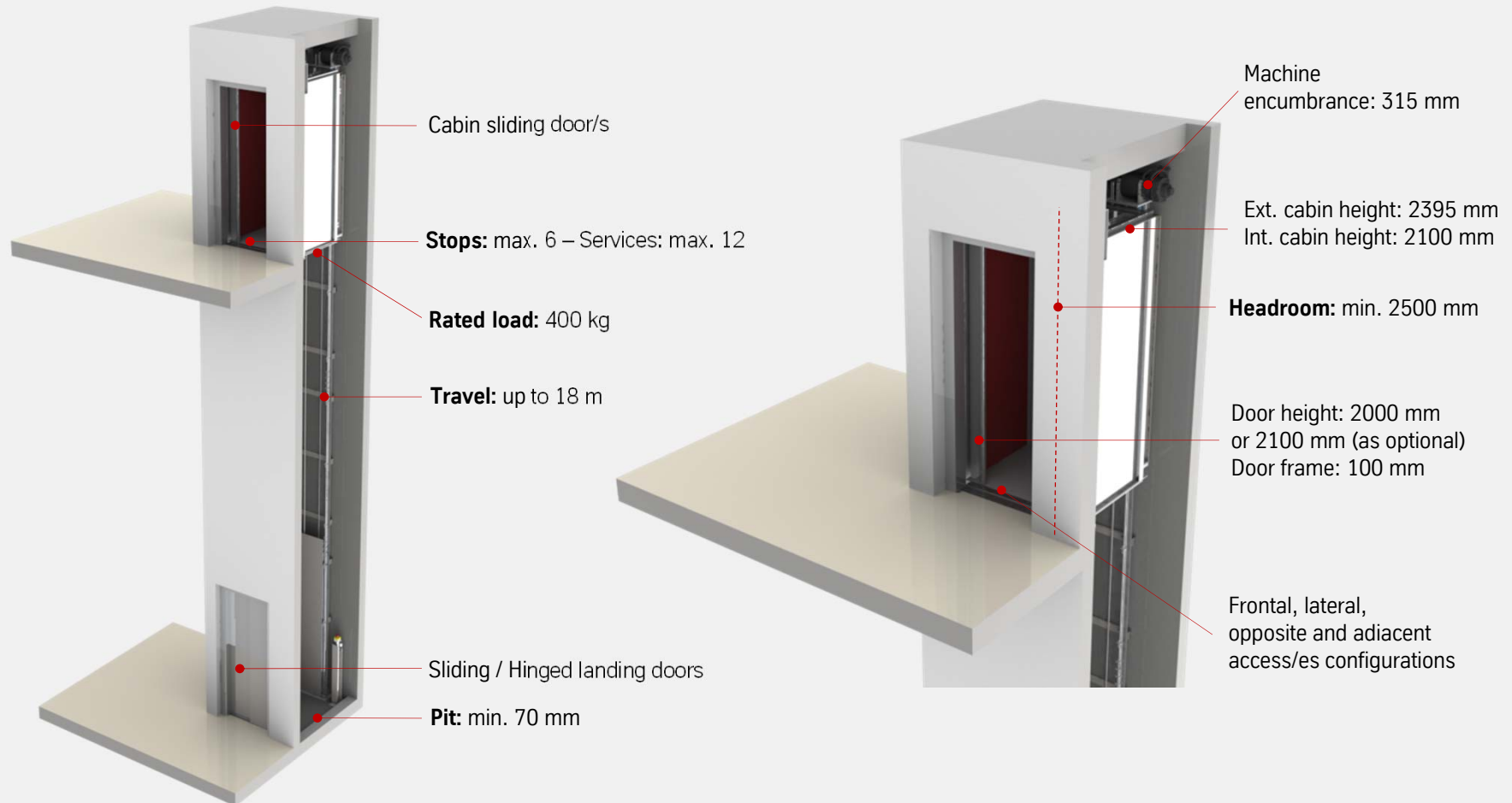

Key technical data

Electric / Electronic data

The electric / electronic devices are:

- **MAINBOARD:** it is an electronic board equipped by three microcontrollers that manages all the machine operation features (machine movement, floors identification, safeties management).
- **POWERBOARD:** it is an electronic board equipped by two contactors that provides the power supply to the motor.
- **INVERTER:** it is an electronic device that manages the motor speed and, in particular, the acceleration / deceleration ramps during the machine operation in close proximity to the landing floors.
- **CABIN DOOR BOARD:** it is an electronic board that manages the cabin door/s opening depending on the floor and basing on the information coming from the sensors on the machine.
- **SENSORS:** sensors with reed contacts (NO type) installed on the car frame. There are three sensors to identify the floor and two sensors to manage the floor leveling and the acceleration / deceleration ramps.
- **MAGNETS:** magnetic plates positioned on the machine guides to identify the floors.
- **UPS:** battery recovery system that allows to complete the chosen travel in case of power outage. In case of fault or battery low charge, an acoustic alert advises the Customer. When the UPS device is not operating, the machine complete the chosen travel and restarts only once the problem is solved.

Key technical data

Technical specifications

Lifting system:	Ropes and counterweight system driven by a gearless motor (suspension ratio 2:1)
Motor:	230 V three-phase, 50/60 Hz
Power supply:	230 ± 10% V single-phase, 50/60 Hz
Power consumption:	Max. 1,5 kW (38 ± 10% W in stand-by)
Rated load:	400 kg
Speed:	0,15 m/s
Travel:	Max. 18 m
Stops:	Max. 6 (max. 12 services)
Headroom:	Min. 2500 mm
Pit:	Min. 70 mm (masonry shaft) – Min. 127* mm (aluminum shaft) – Max. 250 mm
Machine encumbrance:	Width: 1200 mm – Depth: 315 mm
Footprint area:	Max. 1,72 m ²

* = base crossbeam = 114 mm + base door plate = 13 mm

Key technical data

Cabin configurations and materials

The cabin configurations are:

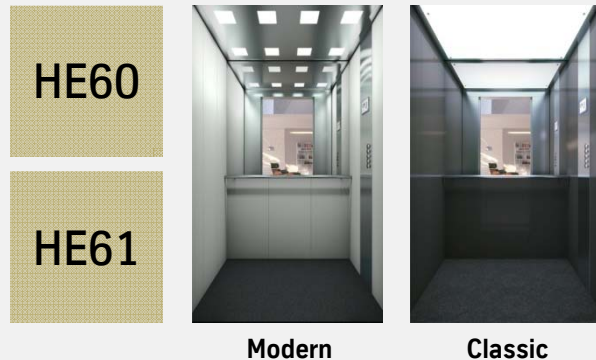

Walls: Load bearing cabin walls composed by vertical panels (standard width about 280 mm) and made of s.steel (classic version) or skinplate (modern version)
Floor: PVC (thickness 2 or 3 mm) or Rocksolid marble grit (thickness 6 mm fixing by glue)
Ceiling: suspended part made of stainless steel or safety glass (height 100 mm)
Devices included: display TFT LCD 64K colors, s.steel central stave, s.steel push buttons with blue lighting, s.steel handrail and Autodialer emergency system.
Devices available as option: mirror (entire height, half height), panoramic wall, s.steel baseboard, Rocksolid floor, Opal glass ceiling version, 4 spot light ceiling version

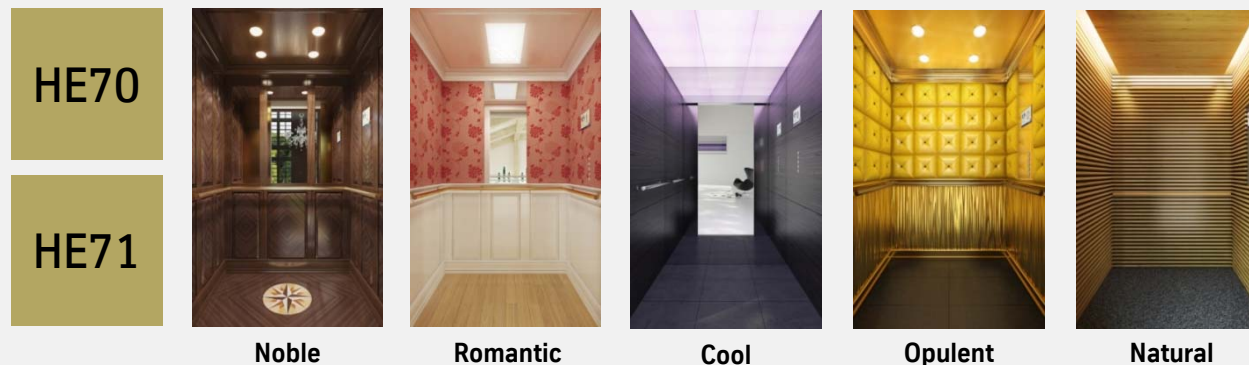

Walls: Load bearing cabin walls covered by various materials, depending on the cabin style.
Floor: depending on the cabin syle.
Devices included: display TFT LCD 64K colors, s.steel central stave, s.steel push buttons with blue lighting, s.steel handrail and Autodialer emergency system.

Key technical data

Cabin configurations and materials

The 6Series cabins are available with the following materials:



Modern

Skin plate walls

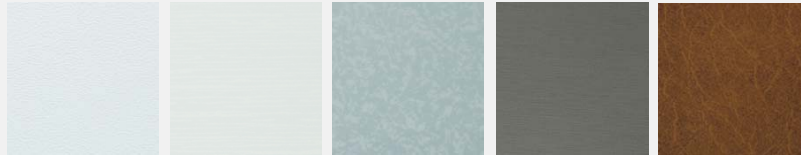

PVC floors



Classic

Stainless steel walls



Rocksolid floors (available as option)



Key technical data

Cabin configurations and materials

The NOBLE cabin is available with the following materials:



- Cabin wall made of veneered wood with decorative surface and raised moldings, dark oak essence.
- Cabin floor made of wood with decorative surface and central inlay.
- Cabin operating panel made of same material of the wall panel.
- Cabin ceiling made of same material of the wall panel. 4 spot lights with gold effect ring (diameter 110mm).
- Handrail in stainless steel gold finishing, diameter 40 mm.

Key technical data

Cabin configurations and materials

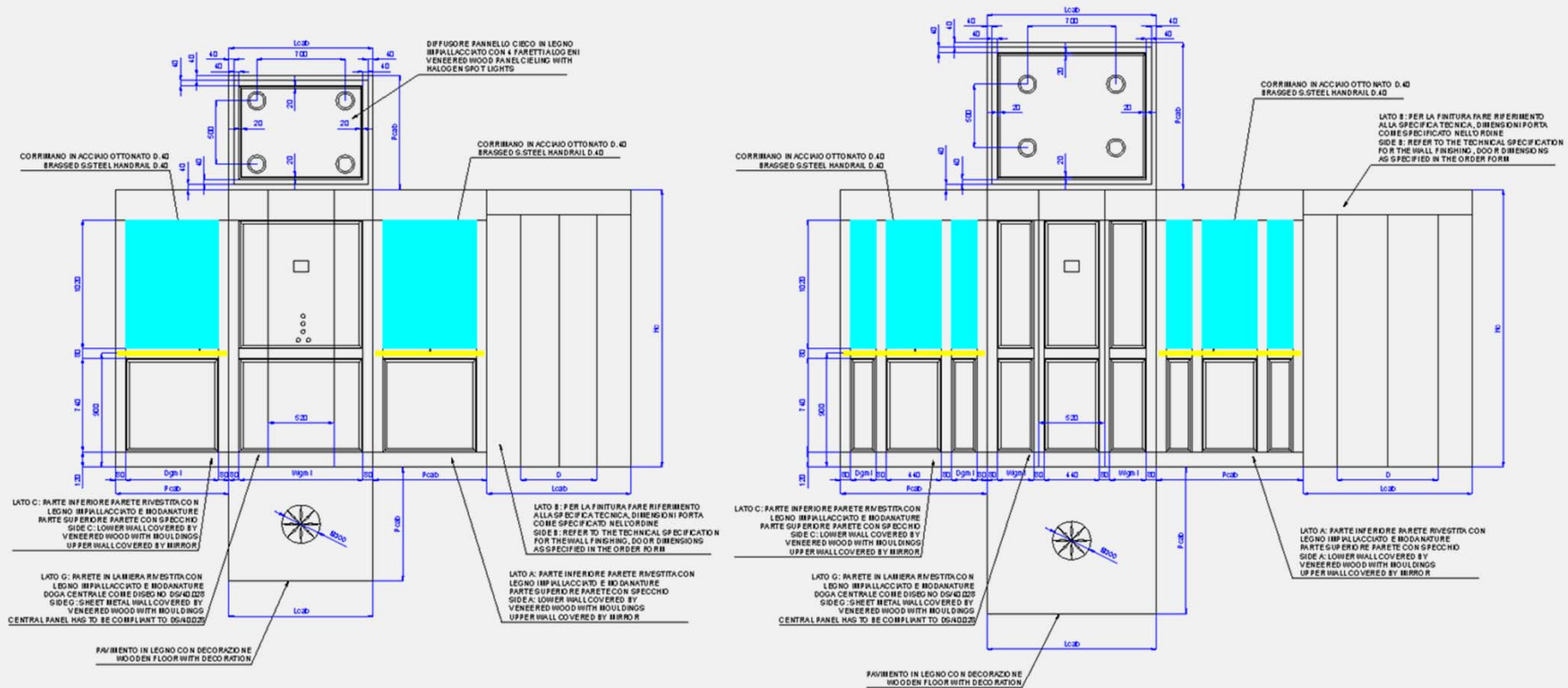

Key technical data

Cabin configurations and materials

The ROMANTIC cabin is available with the following materials:



- Cabin wall made of white veneered wood with raised moldings in the lower part and textile wallpaper in the upper part.
- Cabin floor made of PVC vinyl (printed pattern wood light oak, thickness 2,5 mm).
- Cabin operating panel made of same material of the wall panel.
- Cabin ceiling made of white varnished wood with raised moldings on the perimeter. Embedded light opal glass.
- Handrail in stainless steel gold finishing, diameter 40 mm.

Key technical data

Cabin configurations and materials

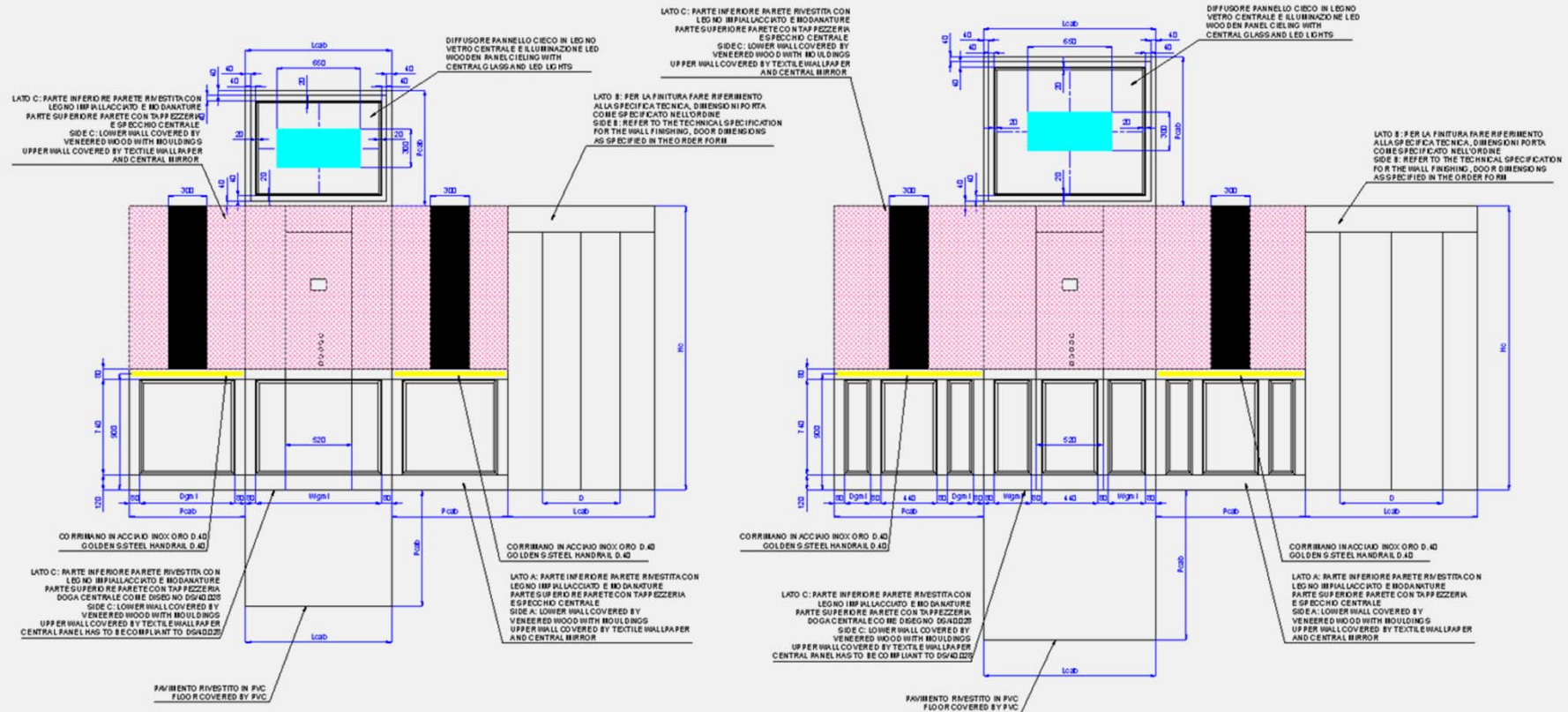

Key technical data

Cabin configurations and materials

The COOL cabin is available with the following materials:

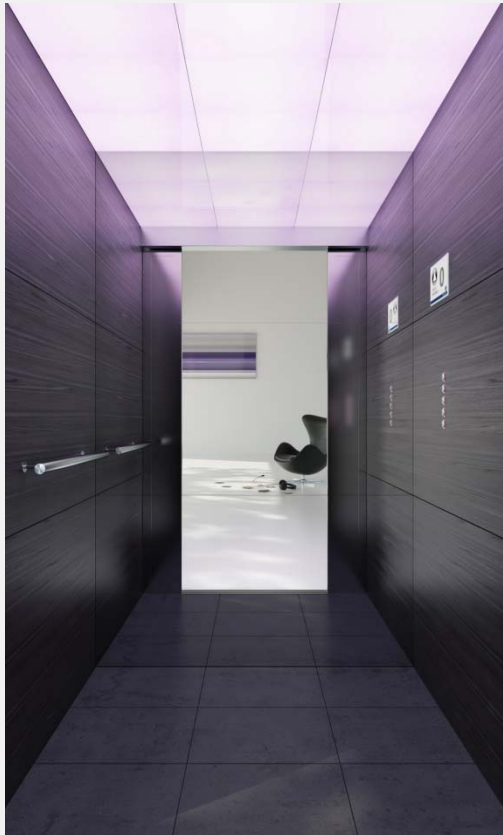

- Cabin wall made of veneered wood with s.steel inlayers, dark ebony essence.
- Cabin floor made of marble grit (rocksolid 630).
- Cabin operating panel made of same material of the wall panel.
- Cabin ceiling made of a glass panel.
- Handrail in stainless steel polished finishing, diameter 40 mm.

Key technical data

Cabin configurations and materials

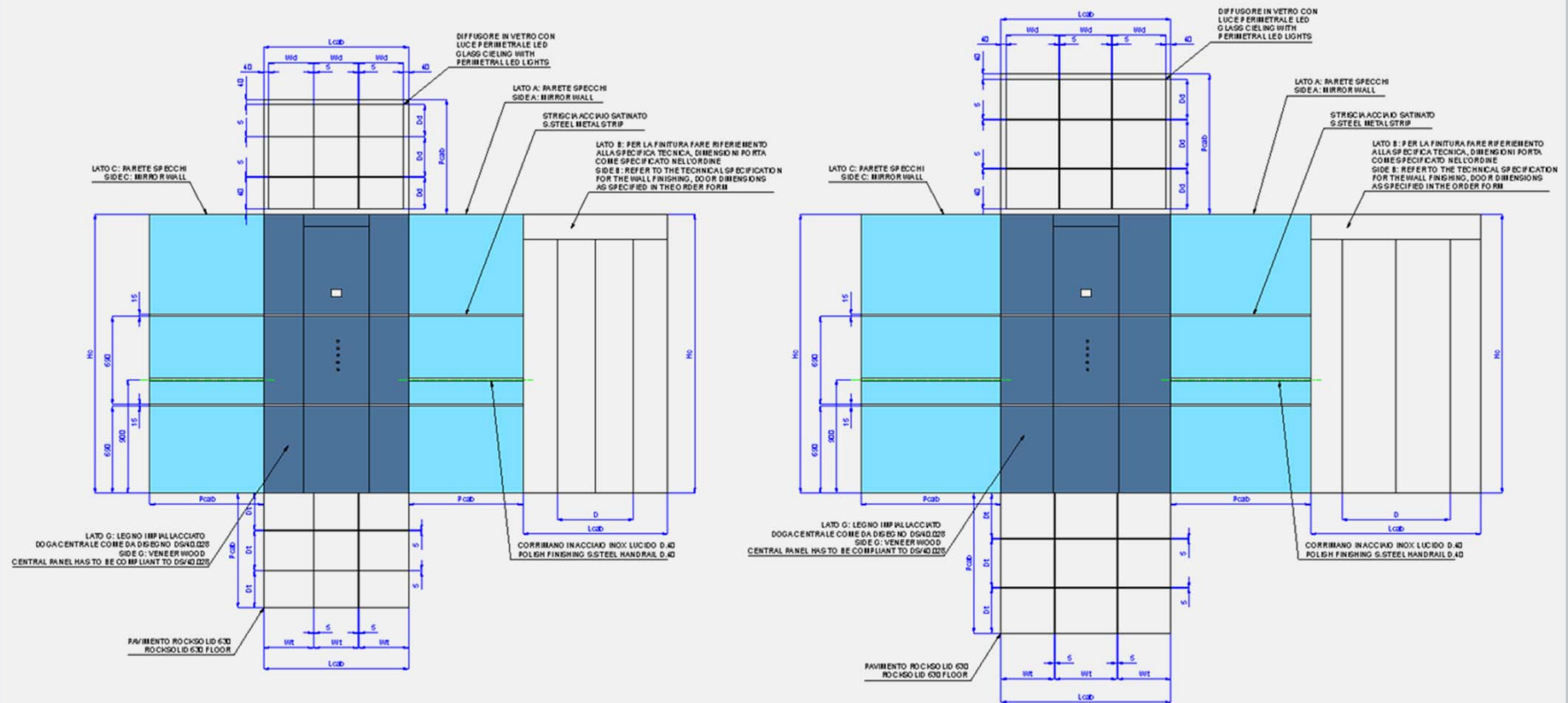

Key technical data

Cabin configurations and materials

The OPULENT cabin is available with the following materials:

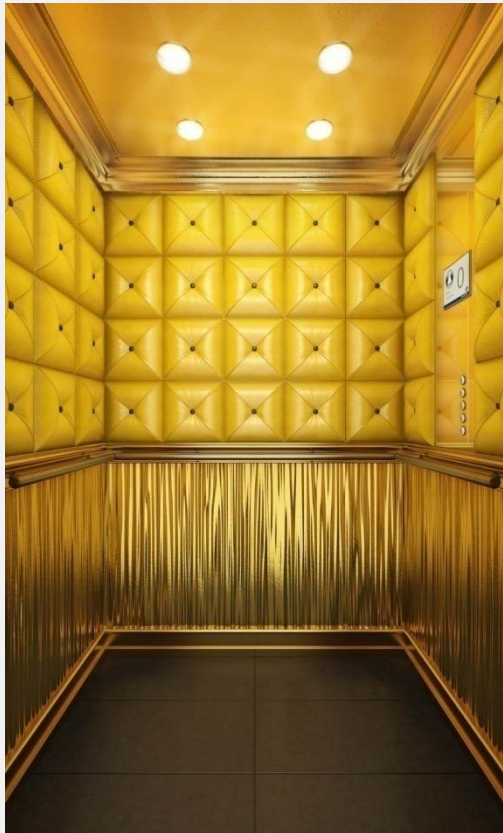

- Cabin wall made of MDF panel with undulating shape and a gold leaf finish in the lower part and 30 mm Leather Pad on a support in the upper part.
- Cabin floor made of marble grit (rocksolid touch 2404).
- Cabin operating panel made of same material of the wall panel in the lower part and s.steel mirror effect in the upper part.
- Cabin ceiling made of same material of the wall panel in the lower part. 4 spot lights with gold effect ring (diameter 110mm).
- Handrail in stainless steel black effect, diameter 40 mm.

Key technical data

Cabin configurations and materials

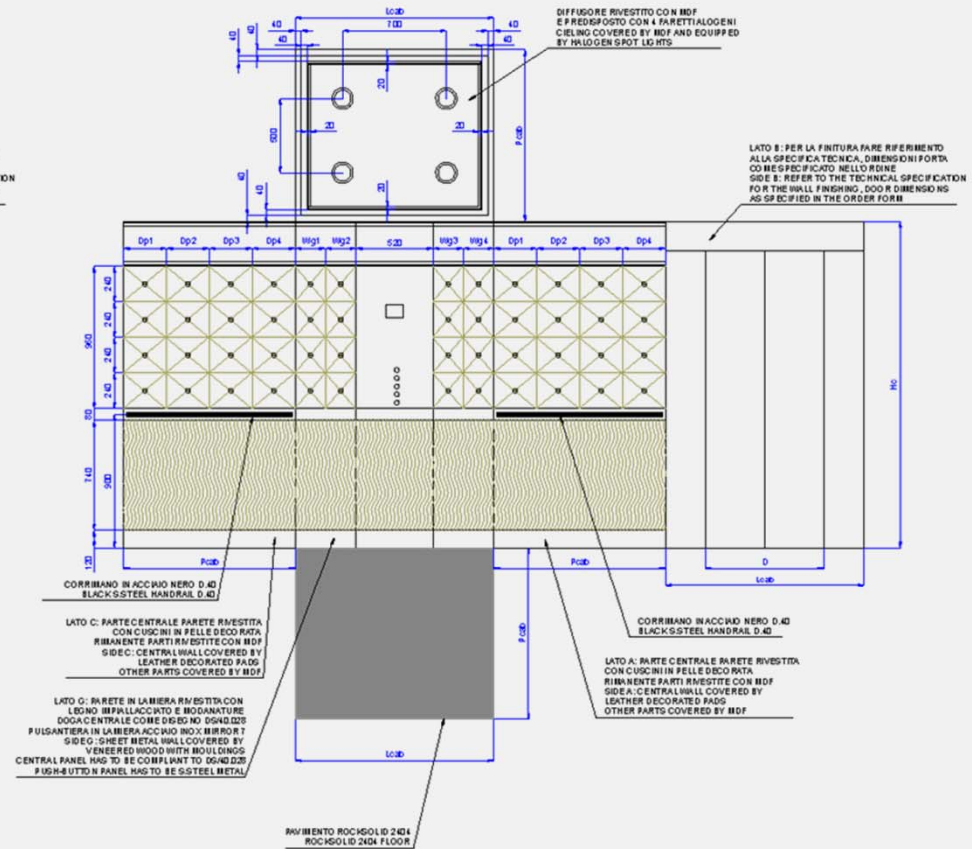
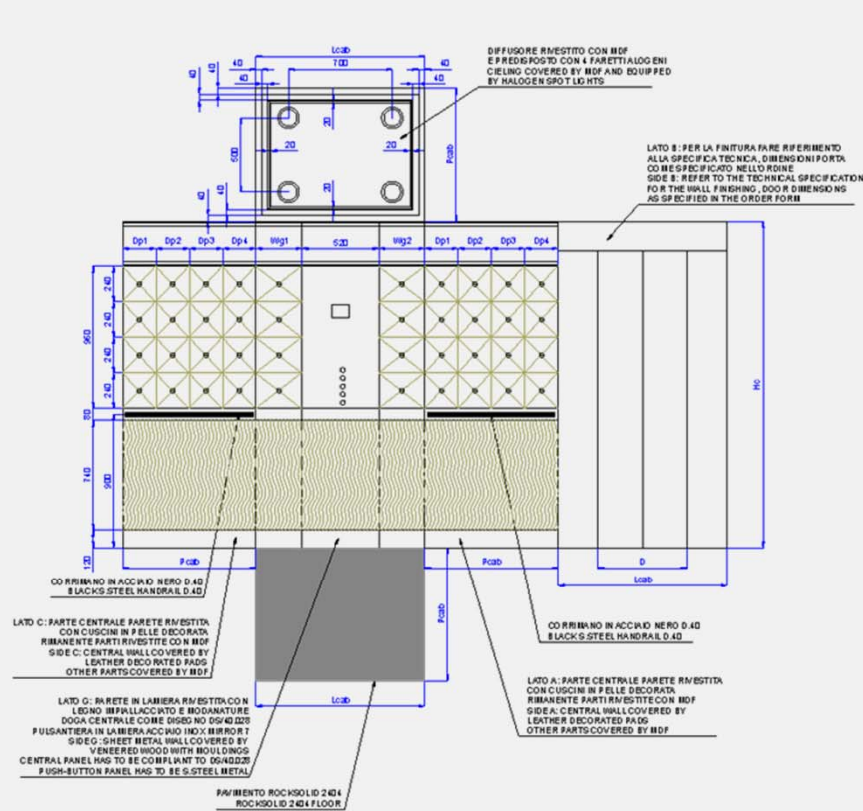

Key technical data

Cabin configurations and materials

The NATURAL cabin is available with the following materials:



- Cabin wall made of black painted structure and wooden battens (20 mm x 28 mm) applied on the structure with a polished treatment on the 3 visible sides.
- Cabin floor made of marble grit (rocksolid touch 2404).
- Cabin operating panel made of same material of the wall panel with a central part in stainless steel for Display and pushbuttons (780 mm x 230 mm).
- Cabin ceiling made of polished wood with LED lights on the internal perimeter.
- Handrail in wood, diameter 30 mm.

Key technical data

Cabin configurations and materials

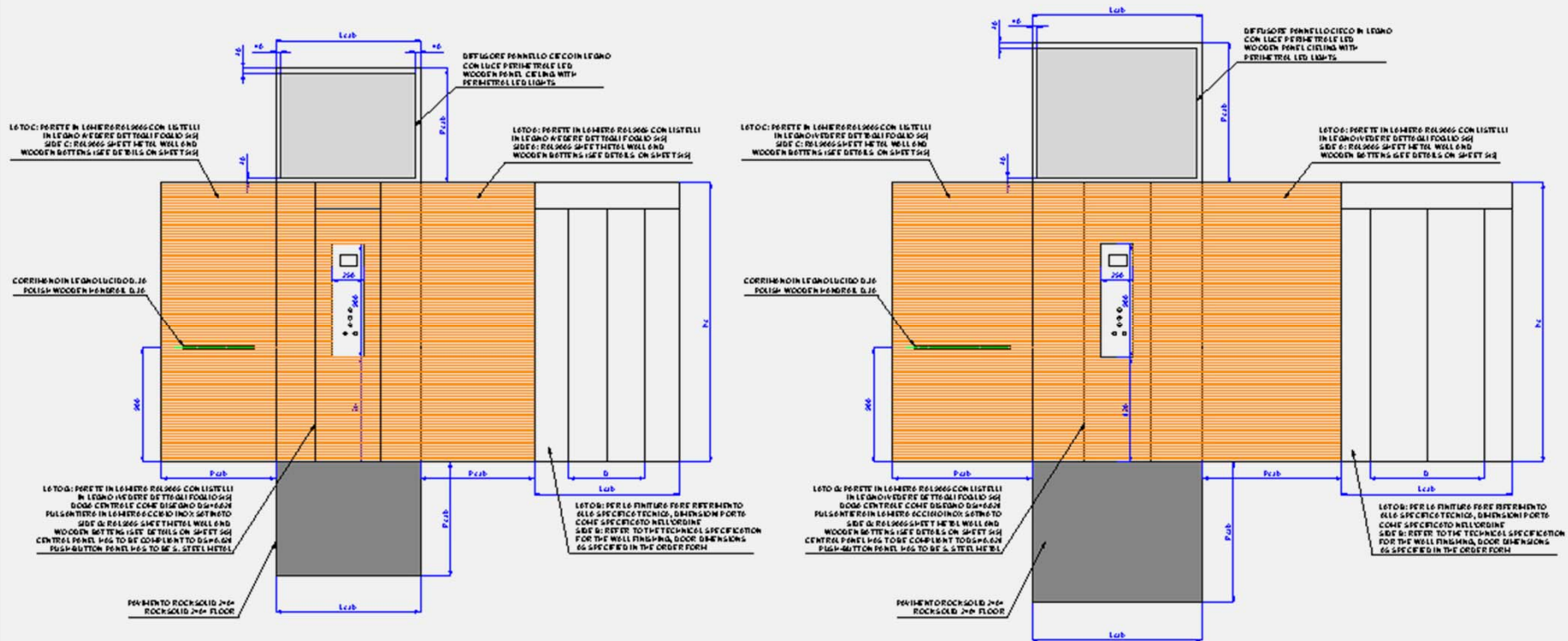

Key technical data

Cabin and shaft dimensions

The cabin dimensions (Lcab x Pcab) and shaft dimensions (L x P) depend on the access/es configuration:

FRONTAL ACCESS

Sliding cabin door
Sliding landing doors

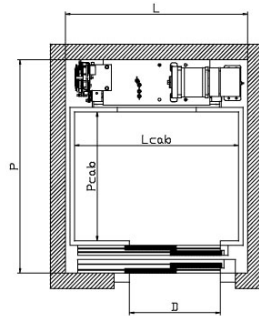

6Series: L min. = 1200 / P min. = 1410. Lcab = L - 110 mm. Pcab = P - 550 mm.

Noble: L min. = 1200 / P min. = 1410. Lcab = L - 130 mm. Pcab = P - 570 mm.

Romantic: L min. = 1200 / P min. = 1410. Lcab = L - 130 mm. Pcab = P - 570 mm.

Cool: L min. = 1200 / P min. = 1410. Lcab = L - 130 mm. Pcab = P - 570 mm.

Opulent: L min. = 1200 / P min. = 1410. Lcab = L - 150 mm. Pcab = P - 590 mm.

Natural: L min. = 1200 / P min. = 1410. Lcab = L - 166 mm. Pcab = P - 606 mm.

Sliding cabin door
Hinged landing doors

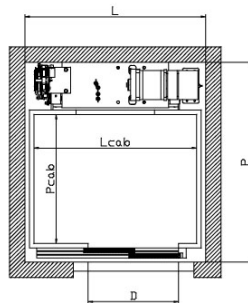

6Series: L min. = 1200 / P min. = 1320. Lcab = L - 110 mm. Pcab = P - 460 mm.

Noble: L min. = 1200 / P min. = 1320. Lcab = L - 130 mm. Pcab = P - 480 mm.

Romantic: L min. = 1200 / P min. = 1320. Lcab = L - 130 mm. Pcab = P - 480 mm.

Cool: L min. = 1200 / P min. = 1320. Lcab = L - 130 mm. Pcab = P - 480 mm.

Opulent: L min. = 1200 / P min. = 1320. Lcab = L - 150 mm. Pcab = P - 500 mm.

Natural: L min. = 1200 / P min. = 1320. Lcab = L - 166 mm. Pcab = P - 516 mm.

Key technical data

Cabin and shaft dimensions

The cabin dimensions (Lcab x Pcab) and shaft dimensions (L x P) depend on the access/es configuration:

LATERAL ACCESS

Sliding cabin door
Sliding landing doors

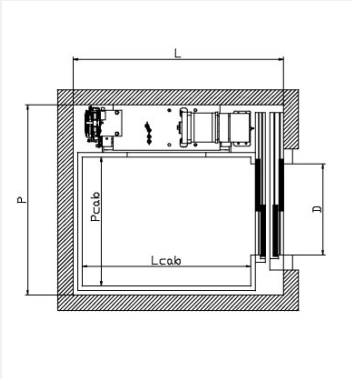

6Series: L min. = 1395 / P min. = 1255. Lcab = L - 265 mm. Pcab = P - 395 mm.
Noble: L min. = 1395 / P min. = 1255. Lcab = L - 285 mm. Pcab = P - 415 mm.
Romantic: L min. = 1395 / P min. = 1255. Lcab = L - 285 mm. Pcab = P - 415 mm.
Cool: L min. = 1395 / P min. = 1255. Lcab = L - 285 mm. Pcab = P - 415 mm.
Opulent: L min. = 1395 / P min. = 1255. Lcab = L - 305 mm. Pcab = P - 435 mm.
Natural: L min. = 1395 / P min. = 1255. Lcab = L - 321 mm. Pcab = P - 451 mm.

Sliding cabin door
Hinged landing doors

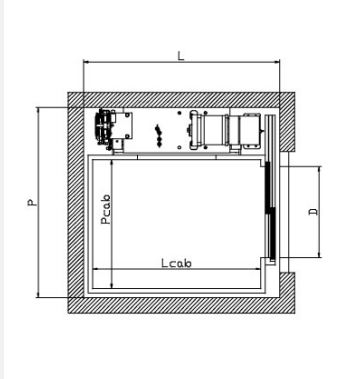

6Series: L min. = 1305 / P min. = 1255. Lcab = L - 175 mm. Pcab = P - 395 mm.
Noble: L min. = 1305 / P min. = 1255. Lcab = L - 195 mm. Pcab = P - 415 mm.
Romantic: L min. = 1305 / P min. = 1255. Lcab = L - 195 mm. Pcab = P - 415 mm.
Cool: L min. = 1305 / P min. = 1255. Lcab = L - 195 mm. Pcab = P - 415 mm.
Opulent: L min. = 1305 / P min. = 1255. Lcab = L - 215 mm. Pcab = P - 435 mm.
Natural: L min. = 1305 / P min. = 1255. Lcab = L - 231 mm. Pcab = P - 451 mm.

Key technical data

Cabin and shaft dimensions

The cabin dimensions (Lcab x Pcab) and shaft dimensions (L x P) depend on the access/es configuration:

OPPOSITE ACCESSES

Sliding cabin door
Sliding landing doors

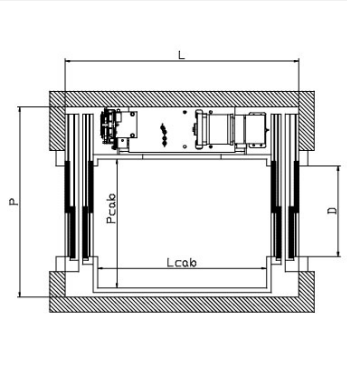

6Series: L min. = 1570 / P min. = 1255. Lcab = L - 420 mm. Pcab = P - 395 mm.

Noble: L min. = 1570 / P min. = 1255. Lcab = L - 440 mm. Pcab = P - 415 mm.

Romantic: L min. = 1570 / P min. = 1255. Lcab = L - 440 mm. Pcab = P - 415 mm.

Cool: L min. = 1570 / P min. = 1255. Lcab = L - 440 mm. Pcab = P - 415 mm.

Opulent: L min. = 1570 / P min. = 1255. Lcab = L - 460 mm. Pcab = P - 435 mm.

Natural: L min. = 1570 / P min. = 1255. Lcab = L - 476 mm. Pcab = P - 451 mm.

Sliding cabin door
Hinged landing doors

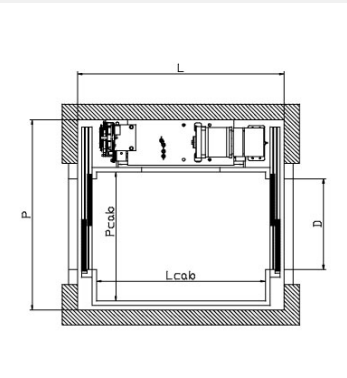

6Series: L min. = 1390 / P min. = 1255. Lcab = L - 240 mm. Pcab = P - 395 mm.

Noble: L min. = 1390 / P min. = 1255. Lcab = L - 260 mm. Pcab = P - 415 mm.

Romantic: L min. = 1390 / P min. = 1255. Lcab = L - 260 mm. Pcab = P - 415 mm.

Cool: L min. = 1390 / P min. = 1255. Lcab = L - 260 mm. Pcab = P - 415 mm.

Opulent: L min. = 1390 / P min. = 1255. Lcab = L - 280 mm. Pcab = P - 435 mm.

Natural: L min. = 1390 / P min. = 1255. Lcab = L - 296 mm. Pcab = P - 451 mm.

Key technical data

Cabin and shaft dimensions

The cabin dimensions (Lcab x Pcab) and shaft dimensions (L x P) depend on the access/es configuration:

ADJACENT ACCESSES

Sliding cabin door
Sliding landing doors

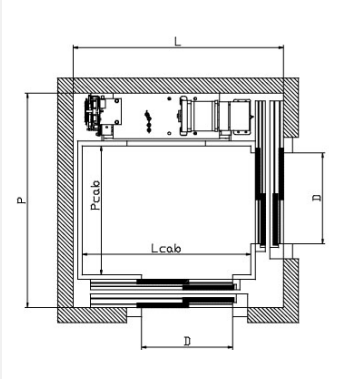

6Series: L min. = 1395 / P min. = 1410. Lcab = L - 175 mm. Pcab = P - 460 mm.
Noble: L min. = 1395 / P min. = 1410. Lcab = L - 285 mm. Pcab = P - 570 mm.
Romantic: L min. = 1395 / P min. = 1410. Lcab = L - 285 mm. Pcab = P - 570 mm.
Cool: L min. = 1395 / P min. = 1410. Lcab = L - 285 mm. Pcab = P - 570 mm.
Opulent: L min. = 1395 / P min. = 1410. Lcab = L - 605 mm. Pcab = P - 590 mm.
Natural: L min. = 1395 / P min. = 1410. Lcab = L - 321 mm. Pcab = P - 606 mm.

Sliding cabin door
Hinged landing doors

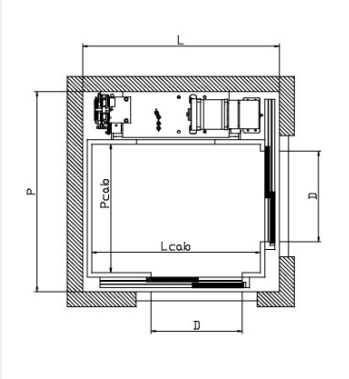

6Series: L min. = 1305 / P min. = 1320. Lcab = L - 175 mm. Pcab = P - 460 mm.
Noble: L min. = 1305 / P min. = 1320. Lcab = L - 195 mm. Pcab = P - 480 mm.
Romantic: L min. = 1305 / P min. = 1320. Lcab = L - 195 mm. Pcab = P - 480 mm.
Cool: L min. = 1305 / P min. = 1320. Lcab = L - 195 mm. Pcab = P - 480 mm.
Opulent: L min. = 1305 / P min. = 1320. Lcab = L - 215 mm. Pcab = P - 500 mm.
Natural: L min. = 1305 / P min. = 1320. Lcab = L - 231 mm. Pcab = P - 516 mm.

Key technical data

Cabin and shaft dimensions

The minimum landing door clear access (D) depend on the shaft dimensions and on the access/es configuration:

FRONTAL ACCESS

Sliding cabin door
Sliding landing doors

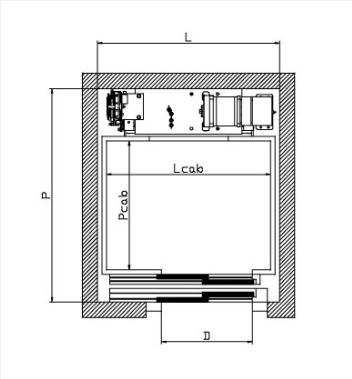

- Clear access 600 mm: $L \geq 1200$ mm
- Clear access 700 mm: $L \geq 1320$ mm
- Clear access 750 mm: $L \geq 1395$ mm
- Clear access 800 mm: $L \geq 1470$ mm
- Clear access 900 mm: $L \geq 1620$ mm

Sliding cabin door
Hinged landing doors

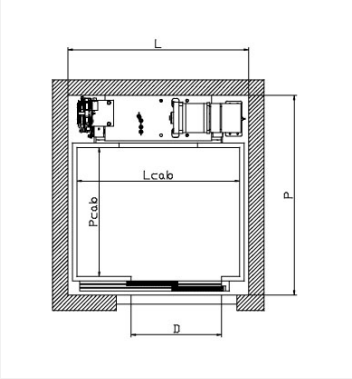

- Clear access 600 mm: $L \geq 1200$ mm
- Clear access 700 mm: $L \geq 1320$ mm
- Clear access 750 mm: $L \geq 1395$ mm
- Clear access 800 mm: $L \geq 1470$ mm
- Clear access 900 mm: $L \geq 1620$ mm

Key technical data

Cabin and shaft dimensions

The minimum landing door clear access (D) depend on the shaft dimensions and on the access/es configuration:

LATERAL ACCESS

Sliding cabin door
Sliding landing doors

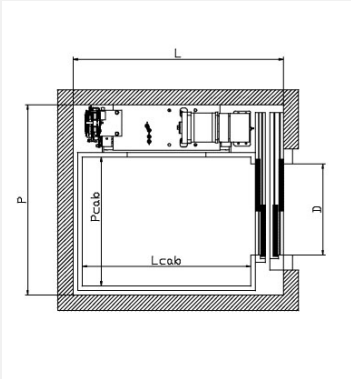

Clear access 600 mm: $P \geq 1255$ mm

Clear access 700 mm: $P \geq 1320$ mm

Clear access 750 mm: $P \geq 1395$ mm

Clear access 800 mm: $P \geq 1470$ mm

Clear access 900 mm: $P \geq 1620$ mm

Sliding cabin door
Hinged landing doors

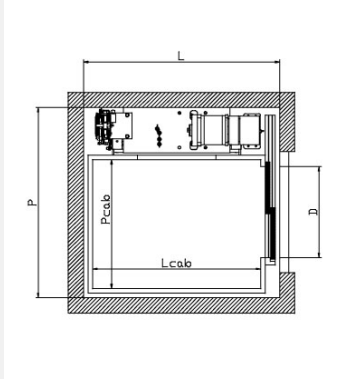

Clear access 600 mm: $P \geq 1255$ mm

Clear access 700 mm: $P \geq 1320$ mm

Clear access 750 mm: $P \geq 1395$ mm

Clear access 800 mm: $P \geq 1470$ mm

Clear access 900 mm: $P \geq 1620$ mm

Key technical data

Cabin and shaft dimensions

The minimum landing door clear access (D) depend on the shaft dimensions and on the access/es configuration:

OPPOSITE ACCESSES

Sliding cabin door
Sliding landing doors

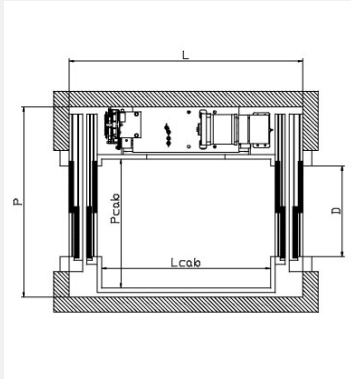

Clear access 600 mm: $P \geq 1255$ mm

Clear access 700 mm: $P \geq 1320$ mm

Clear access 750 mm: $P \geq 1395$ mm

Clear access 800 mm: $P \geq 1470$ mm

Clear access 900 mm: $P \geq 1620$ mm

Sliding cabin door
Hinged landing doors

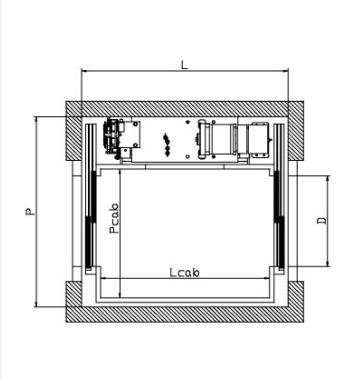

Clear access 600 mm: $P \geq 1255$ mm

Clear access 700 mm: $P \geq 1320$ mm

Clear access 750 mm: $P \geq 1395$ mm

Clear access 800 mm: $P \geq 1470$ mm

Clear access 900 mm: $P \geq 1620$ mm

Key technical data

Cabin and shaft dimensions

The minimum landing door clear access (D) depend on the shaft dimensions and on the access/es configuration:

ADJACENT ACCESSES

Sliding cabin door
Sliding landing doors

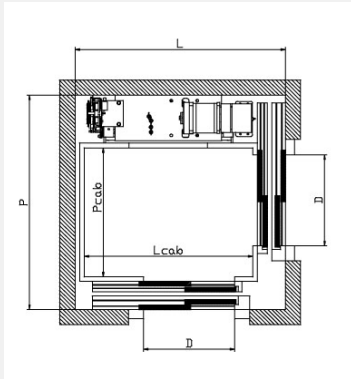

Clear access 600 mm: $L \geq 1395$ mm; $P \geq 1410$ mm
Clear access 700 mm: $L \geq 1445$ mm; $P \geq 1445$ mm
Clear access 750 mm: $L \geq 1520$ mm; $P \geq 1520$ mm
Clear access 800 mm: $L \geq 1595$ mm; $P \geq 1595$ mm
Clear access 900 mm: $L \geq 1745$ mm; $P \geq 1745$ mm

Sliding cabin door
Hinged landing doors

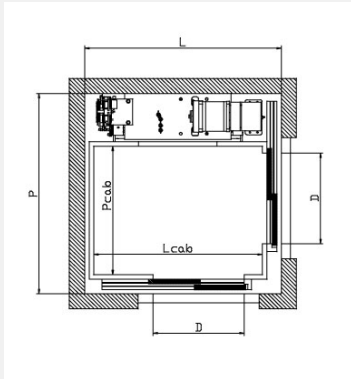

Clear access 600 mm: $L \geq 1305$ mm; $P \geq 1320$ mm
Clear access 700 mm: $L \geq 1355$ mm; $P \geq 1355$ mm
Clear access 750 mm: $L \geq 1430$ mm; $P \geq 1430$ mm
Clear access 800 mm: $L \geq 1505$ mm; $P \geq 1505$ mm
Clear access 900 mm: $L \geq 1655$ mm; $P \geq 1655$ mm

Benefits

Benefits

Table of contents

- Gearless technology
-

- Mechanical constructions
-

- Electronics
-

- Vibrations
-

- Noise
-



Benefits

Gearless technology

Energy Efficiency

Low Noise

Max. precision on acceleration and stop

Environmental Friendly

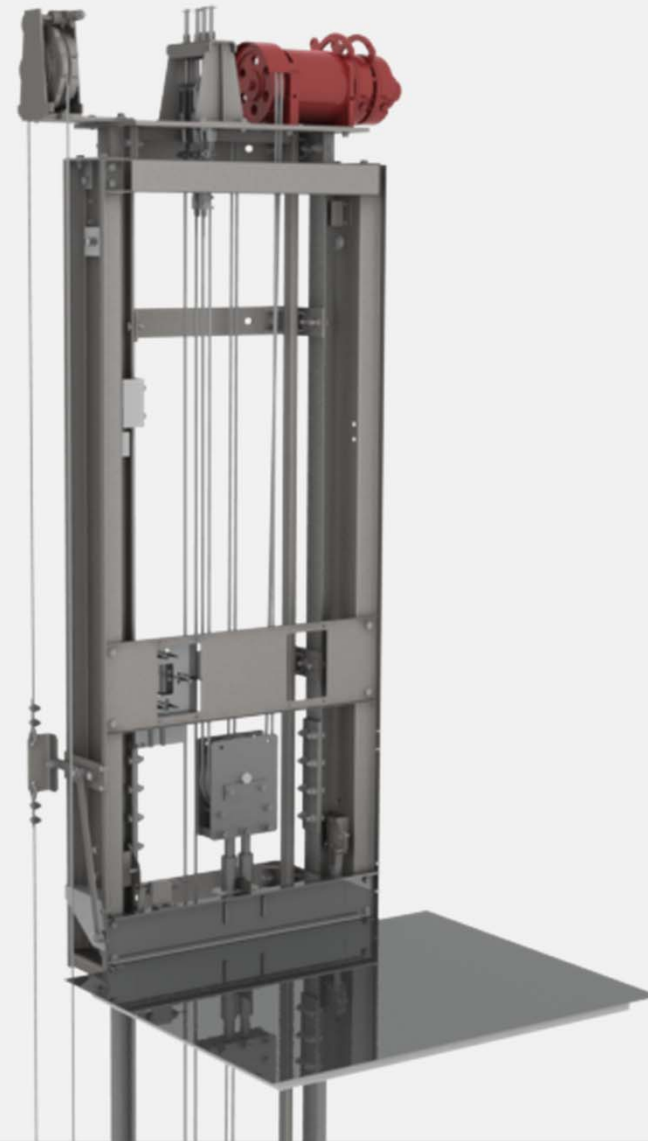

Benefits

Mechanical constructions

Ropes and counterweigh

Robust construction

Rated load: 400 kg

Compact design



Benefits Electronics

Patented electronic system

Stops electronically controlled

UPS recovery system

Fine tuning

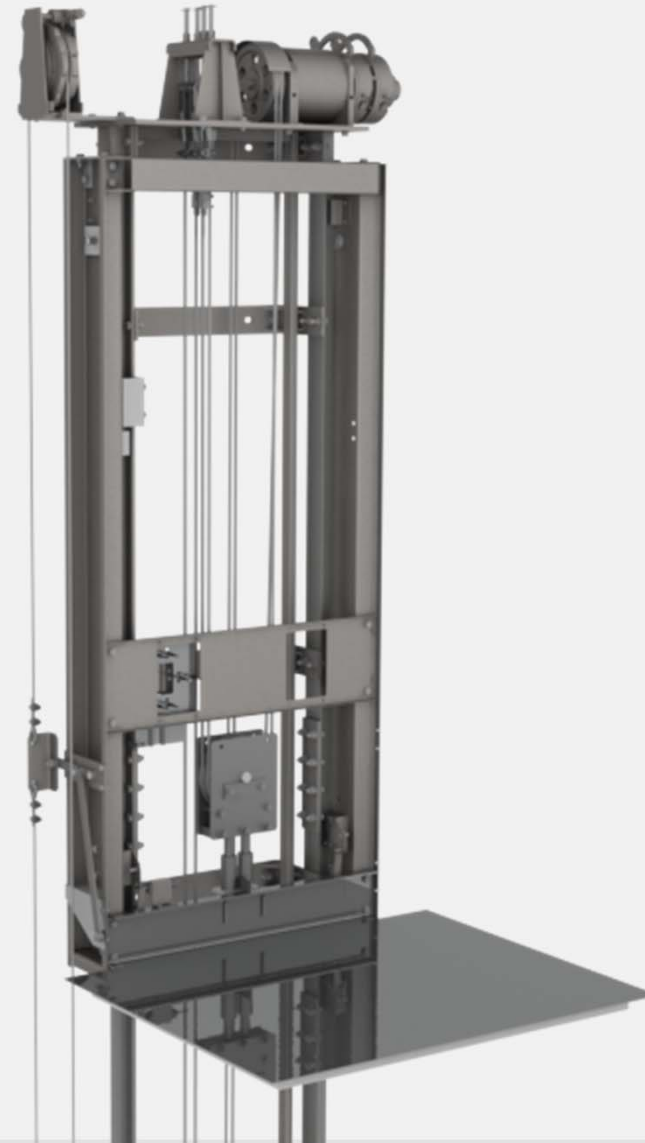

Benefits

Vibrations



Ball screw technology

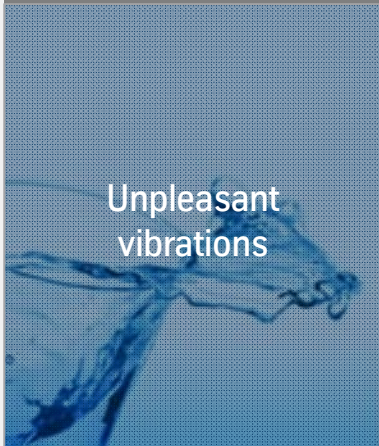

Unpleasant vibrations



Hydraulic technology

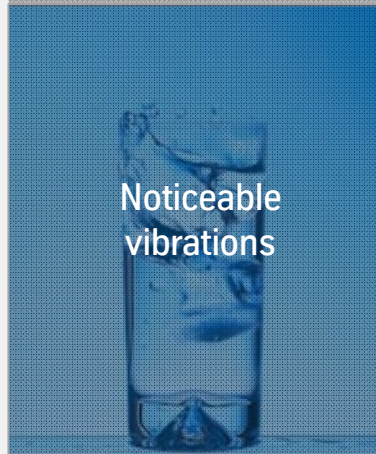

Noticeable vibrations



Gearless technology



Nearly perfectly stable



Benefits

Noise



Ball screw technology



Low volume
of radio
or TV at 1 m
distance



Hydraulic technology

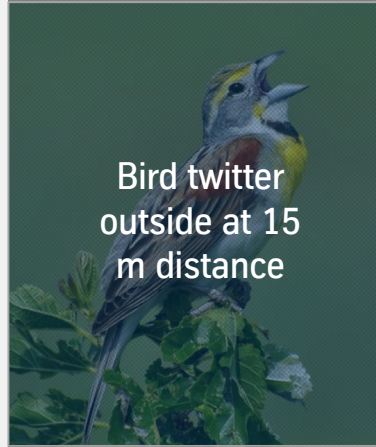

Bird twitter
outside at 15
m distance



Gearless technology

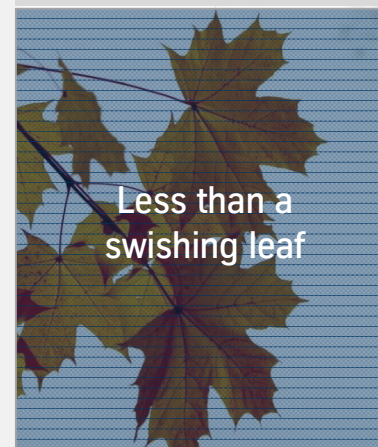

Less than a
swishing leaf



Applications

Applications

Table of contents

- Masonry shaft

- Aluminum shaft

- Cabin and landing door/s



Applications

Masonry shaft



Shaft characteristics

- The machine shall be installed in a completely smooth masonry shaft with no protrusions or recesses.
- Maximum protrusion, if ariswise: $\leq 1,5$ mm.
- Maximum protrusion, if with bevelling less than 15° with respect to the vertical: 5 mm.

Landing accesses

Maximum two for each landing floor, possible in two solutions:

- With hinged doors (to be installed during the masonry activities)
- With sliding doors (to be installed during the installation activities)

Applications

Aluminum shaft



Aluminum shaft characteristics

The structure of the aluminum lift enclosure consists of extruded profiles in 6063 T6 aluminum alloy.

Each profile is anodized (degree of penetration between 8 and 20 microns) to protect it from corrosion.

Painting (available upon request) is in polyester powders.

The aluminum lift enclosure is intended for use in environments with temperatures between -20°C and $+60^{\circ}\text{C}$.

Landing accesses

Maximum two for each landing floor, possible in two solutions:

- With hinged doors (to be installed during the masonry activities)
- With sliding doors (to be installed during the installation activities)

Applications

Aluminum shaft

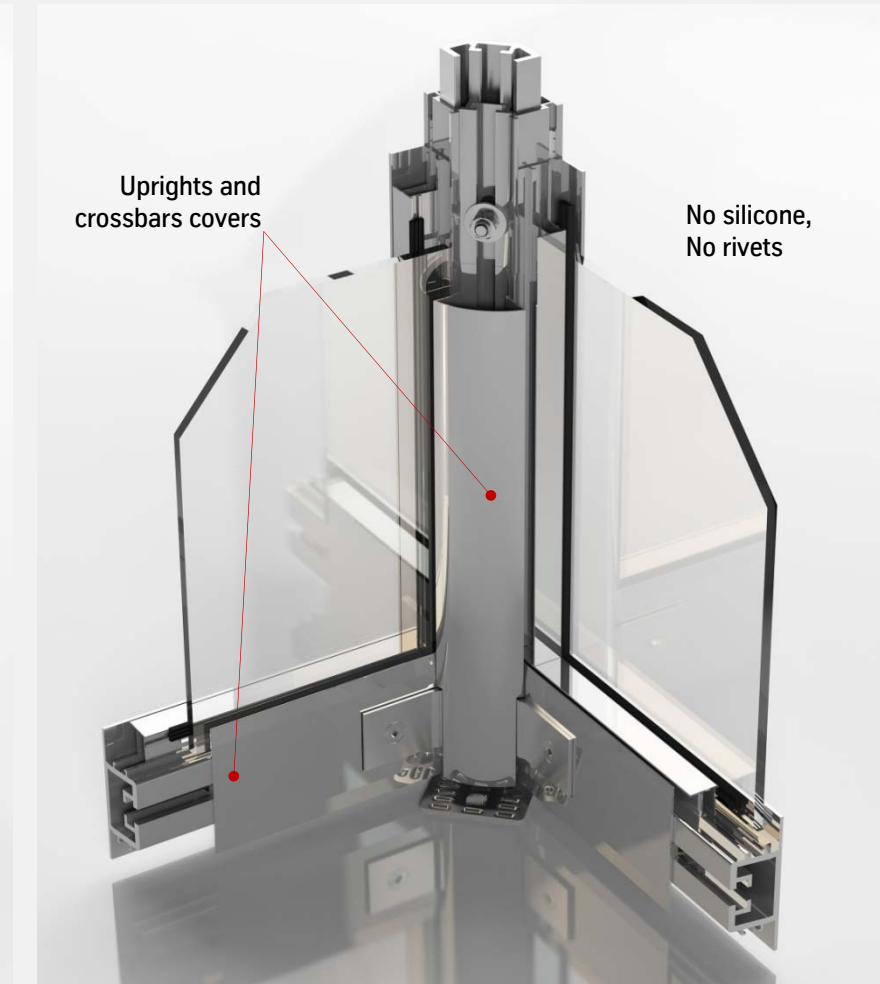
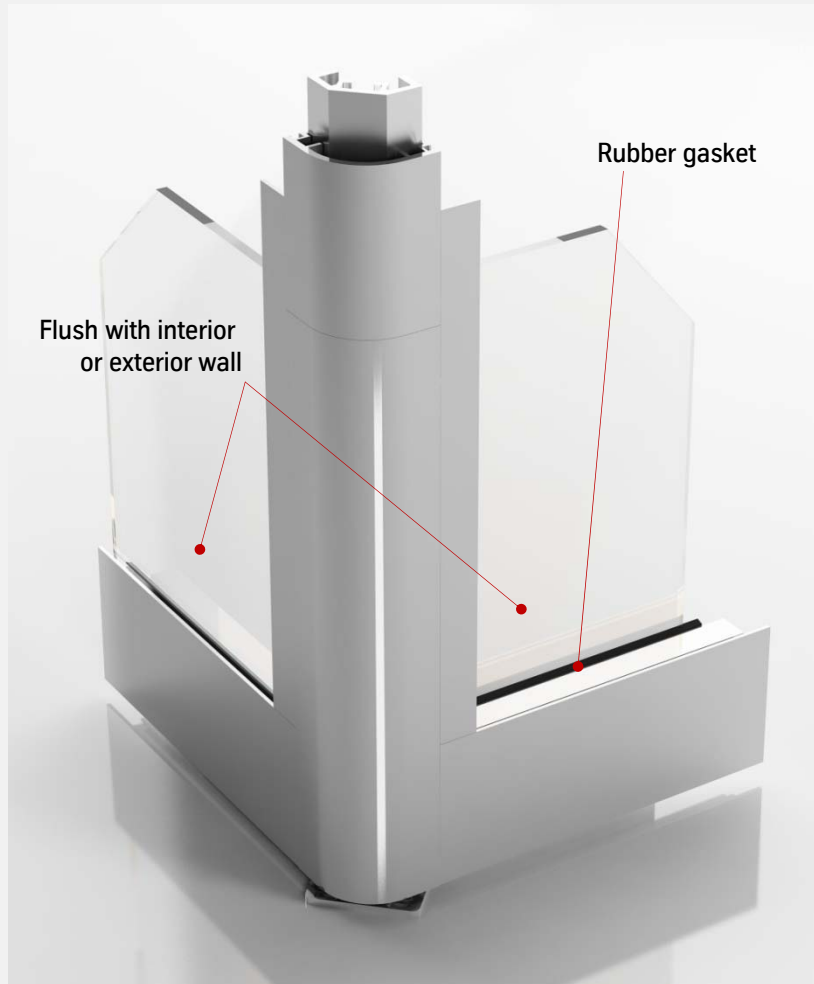

Applications

Cabin and landing doors

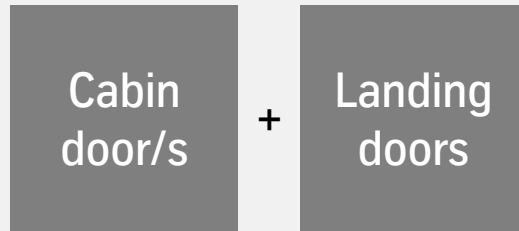

Sliding doors

- Steel RAL painted
- Steel covered with s.steel 304 grit 240
- Steel covered with s.steel mirror effect
- Steel covered with s.steel gold mirror effect
- Glass panoramic version with s.steel frame

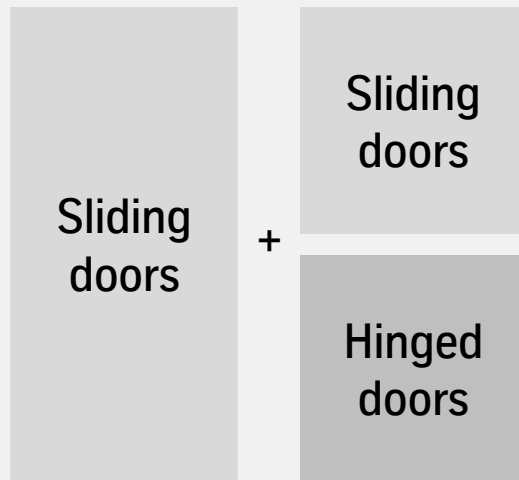

Hinged doors

- Aluminum natural anodized
- Aluminum RAL painted
- Aluminum Silver polish finish

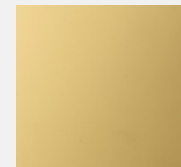
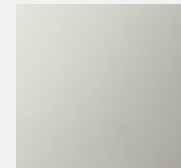

Applications

Cabin and landing doors

Sliding doors – Lateral opening

- The door height (TH) is 2000 mm (2100 mm version available as option)
- The door frame has posts with dimensions 100 mm on each side excluding the bottom side.
- The door encumbrance in the shaft is 90 mm.
- The opening can be right or left with two panels.
- The lock release has a triangular key provided with each machine.

Door clear access (TB)	Total width
600 mm	1042 mm
700 mm	1192 mm
750 mm	1267 mm
800 mm	1342 mm
900 mm	1492 mm

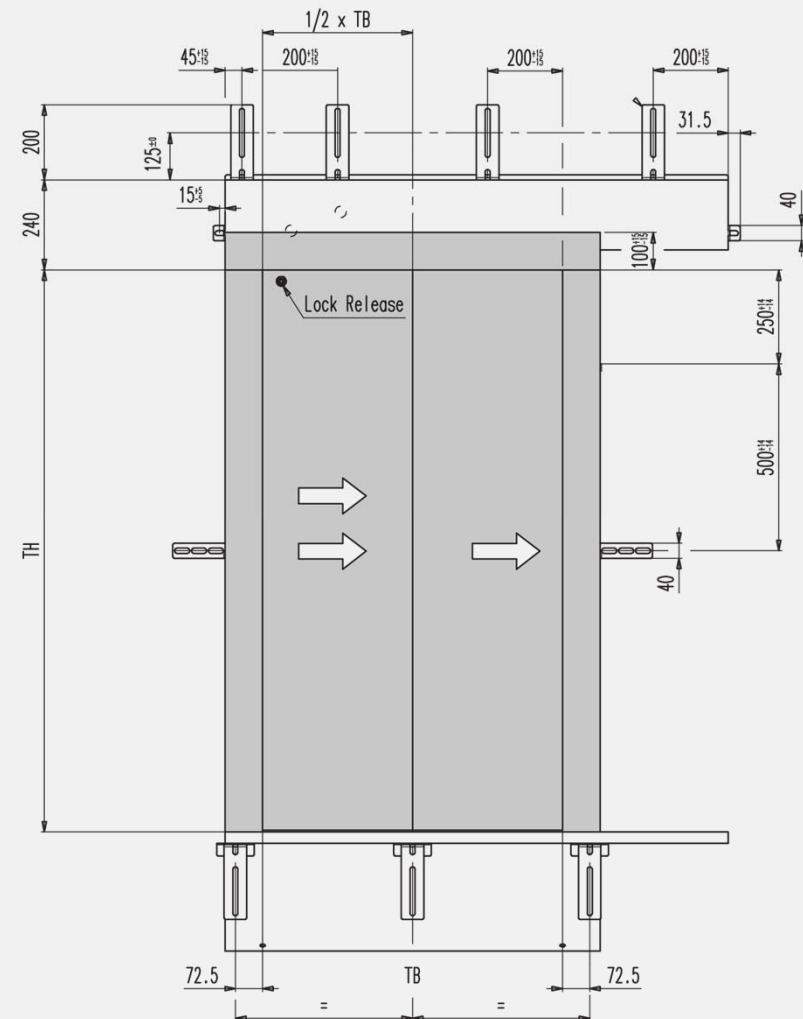

Applications

Cabin and landing doors

Sliding doors – Lateral opening – Glass version

- The glass version has the same features of the blind version (dimensions, finishes, etc.).
- The frame of the glass panels has dimensions 50 mm for the top side and on the lateral sides; 105 mm for the bottom side.
- The glasses dimensions depend on the door clear access as shown in the picture.

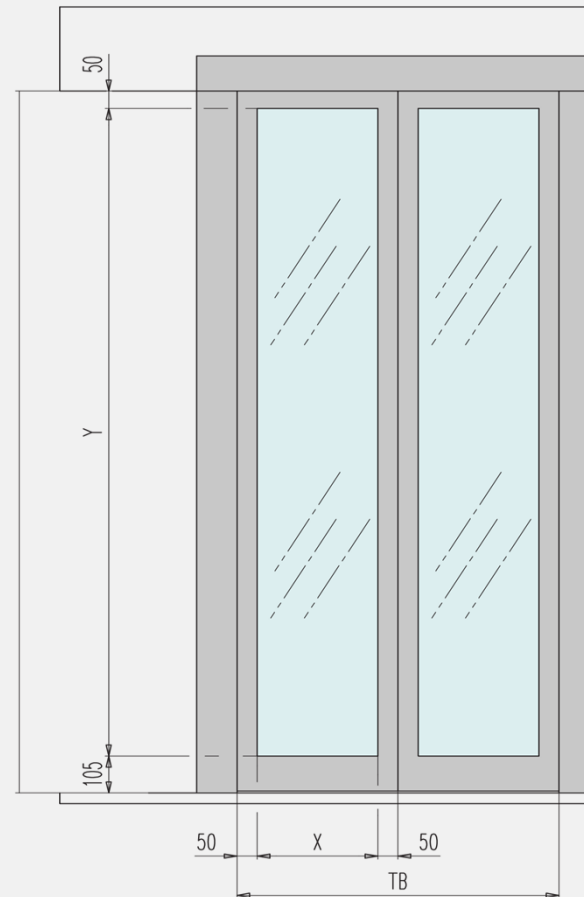

Applications

Cabin and landing doors

Sliding doors – Central opening

- The door height (TH) is 2000 mm (2100 mm version available as option)
- The door frame has posts with dimensions 100 mm on each side excluding the bottom side.
- The door encumbrance in the shaft is 90 mm.
- The opening is central with four panels.
- The lock release has a triangular key provided with each machine.

Door clear access (TB)	Total width
600 mm	1020 mm (1070 mm*)
700 mm	1120 mm (1170 mm*)
750 mm	1195 mm
800 mm	1270 mm
900 mm	1420 mm

* Door height: 2100 mm

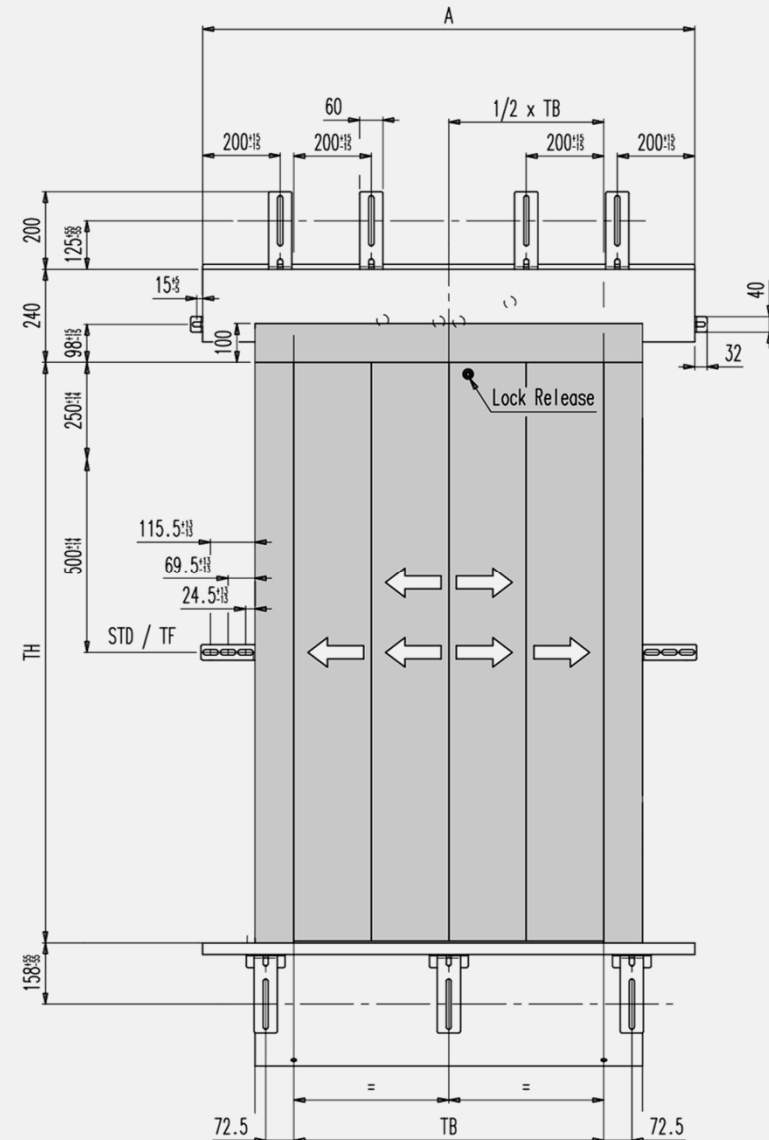

Applications

Cabin and landing doors

Sliding doors – Central opening – Glass version

- The glass version has the same features of the blind version (dimensions, finishes, etc.).
- The frame of the glass panels has dimensions 50 mm for the top side and on the lateral sides; 105 mm for the bottom side.
- The glasses dimensions depend on the door clear access as shown in the picture.

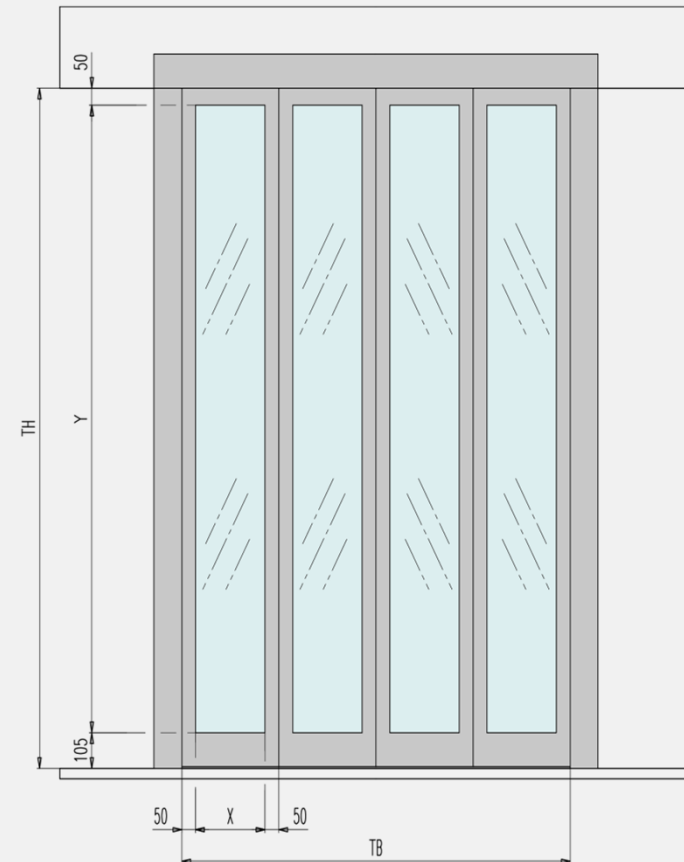

Main components and options

Main components and options

Table of contents

- Display
- Lighting systems
- Push buttons
- 6Series options
- Aluminum shaft options



Main components and options

Display

Features and layouts

- 5.7" TFT LCD 320xRGBx240 Dots, 65Kcolors.
- It is possible to set 4 different graphic layouts
- Floor indication
- Date and time indication
- Operation indication with icons (movement, alerts, etc.)

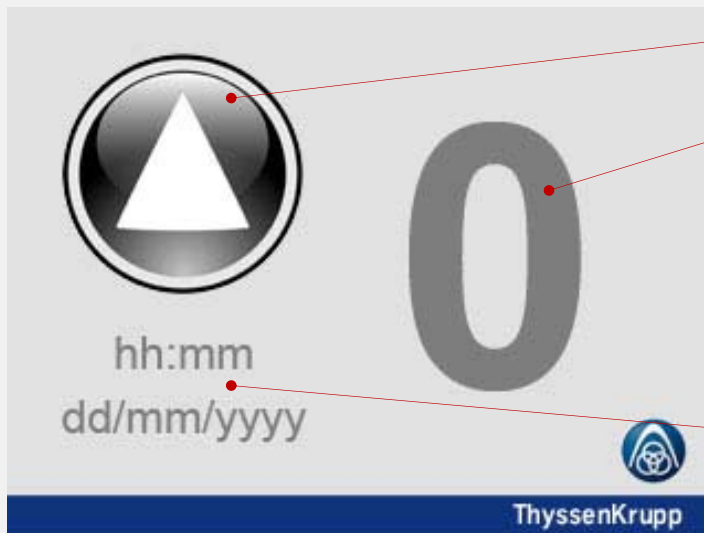

Operation indications with icons

Floor indication

Date and time indication

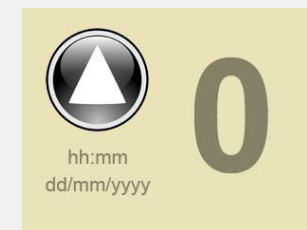
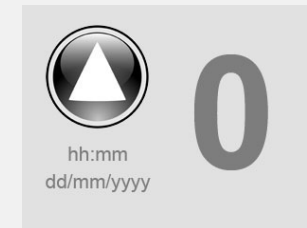

Main components and options

Display

Icons and meaning of the icons



Upward movement



Downward movement



Automatic descent to the ground floor with acoustic alert



Door opened



UPS operation
In case of power outage, the UPS guarantee the chosen travel but it won't be possible to use again the machine until the power supply is restored



Safety device enable
A technical inspection is needed



Emergency "User alarm" enable
The autodialer system call the preset phone number and connect the User with the external receiver



Overload sensor enable
It is necessary to remove the load on the platform and wait the overload sensor automatic restore.



Main components and options

Lighting system

6Series

- 4 florescent lamps, (13W for each lamp) with s.steel ceiling
- 4 florescent lamps (13W for each lamp) with opal glass ceiling (available as option)
- 4 spot halogen lamps (10W for each lamp) with s.steel ceiling (available as opt)



7Series

- 4 spot halogen lamps (10W for each lamp) with specific ceiling depending on the cabin style (NOBLE, OPULENT)
- LED stripes system on the ceiling perimeter (NATURAL, COOL) or in correspondence of the glass ceiling part (ROMANTIC)

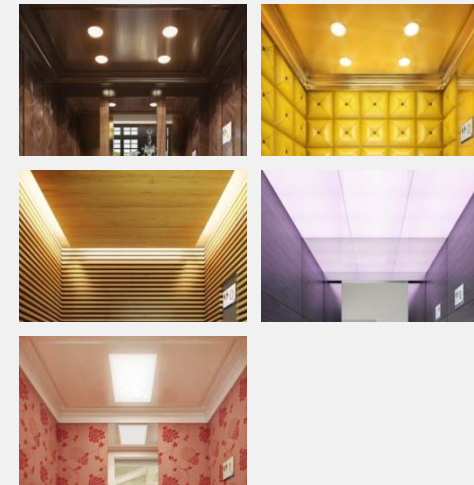

Main components and options

Pushbuttons

Features and lighting

- Body: made of s.steel, vandal-resistant, compliant to the EN81-71.
- Lighting: LED 24 Vdc available in blue, amber and red lighting colours.
- Black s.steel plate with embossed brushed symbols.

Versions

- Floor selection
- Door opening – Change direction
- User alarm

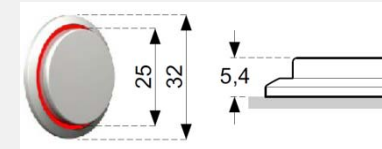

Main components and options

6Series options

Rocksolid floors



- Thickness: 6 mm

Ceiling



- 4 spot halogen spots (10 W for each lamp)



- Opal glass 5+0,76+5 with Florescent lamps

Mirror



- Half height or full height versions.
- The handrail will be place on the mirror side, fixed on the lateral cabin walls

Panoramic wall

- Glass 5+0,76+5
- S.steel frame

Baseboard

- Made of s.steel
- Height 60 mm

Main components and options

Aluminum shaft options

Honeycomb roof
(outdoor vers.)



- Thickness: 15 mm.
- It is possible to adjust the inclination during the installation phase.

Single skin
aluminum roof (indoor vers.)



- Thickness: 1,2 mm.
- It is possible to adjust the inclination during the installation phase or order a version cashed in the shaft posts.

Door canopy
with transparent glass



- Iron structure
- Glass: 5 mm + 0,76 mm + 5 mm

Required construction works and predispositions

Required construction works and predispositions

Shaft predisposition

- Shaft predispositions

- Anchors

- Landing doors predispositions

- Electrical panel

- Electrical connections



Required construction works and predispositions

Shaft predisposition

Shaft measurements

In order to guarantee a proper shaft measurement, it is necessary to measure the shaft plan size at the upper stop and at the bottom floor.

The suggested procedure is:

- measure the shaft width (L) on two shaft sides;
 - measure the shaft depth (P) on two shaft sides;
 - measure one of the diagonal of the shaft plan;
 - measure the possible out of plumb of the shaft walls or the diagonals of the entire shaft walls.
- The L and P measurements to be considered are the minimum ones.
- The measurements should be performed by skilled persons.

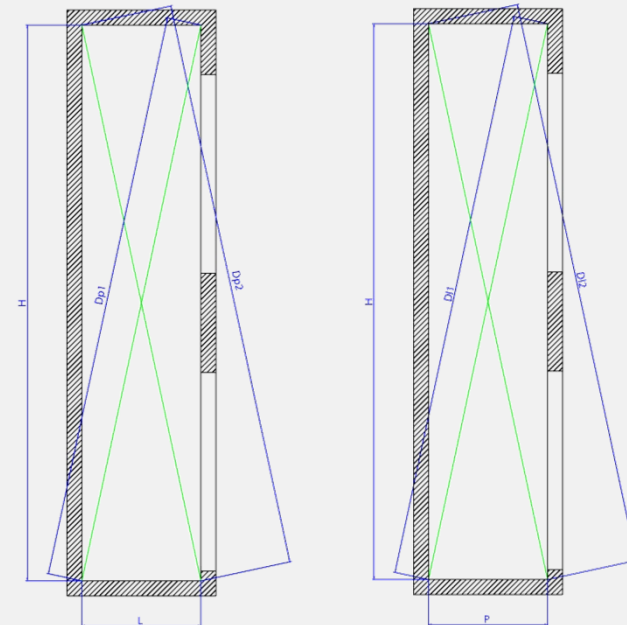
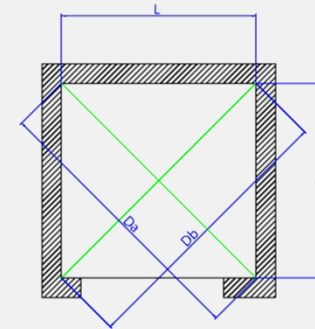

Required construction works and predispositions

Anchors

The guide anchorage are possible in three possible way:

- with mechanical expansion bolts in steel $\varnothing 14$ (only for reinforced concrete walls);
- with Halfen brackets and M12 bolts;
- via welding on a prepared vertical structure.

→ Refer to the “Pre-installation Manual” to consult the technical instructions

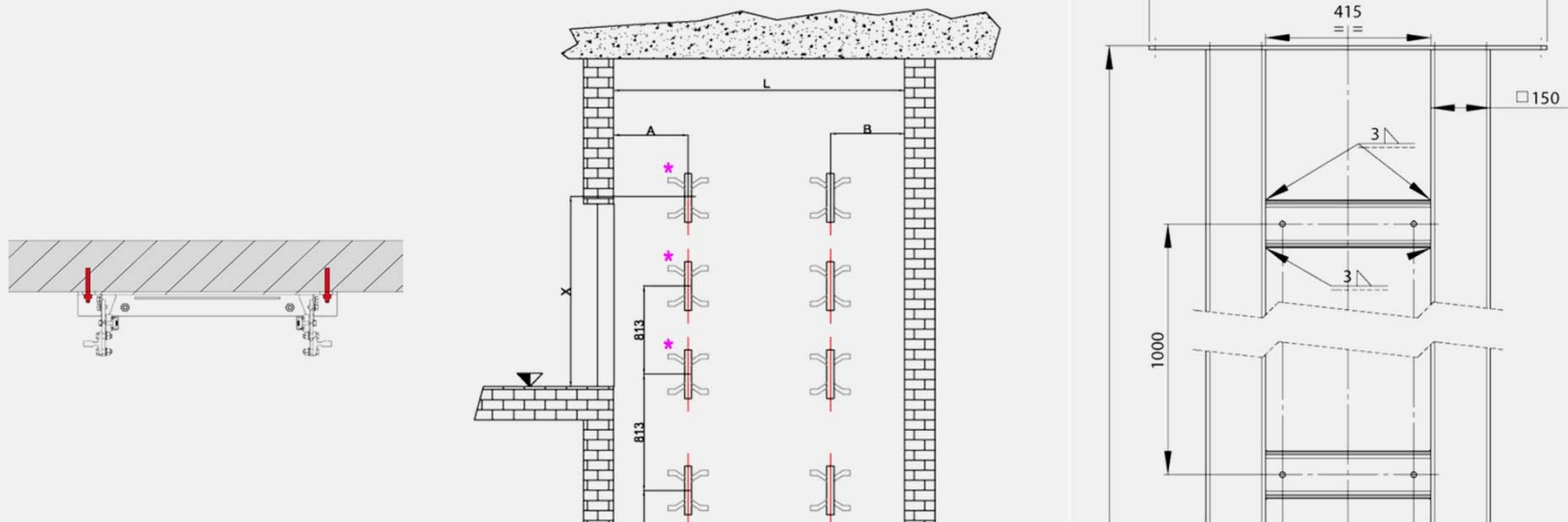

Required construction works and predispositions

Landing door predisposition

Landing doors

- Hinged doors: to be installed during the predisposition phase under the Customer responsibility.
 - Sliding doors: to be installed during the installation phase by our technicians.
- **Attention!** In case of double access on the cabin (opposite or adjacent) and in case one of these accesses is used only from the bottom floor, it is necessary to set a 250 mm pit to guarantee the necessary space for the door operator installation.
- Refer to the “Pre-installation Manual” and to the “Installation Manual” to consult the technical instructions

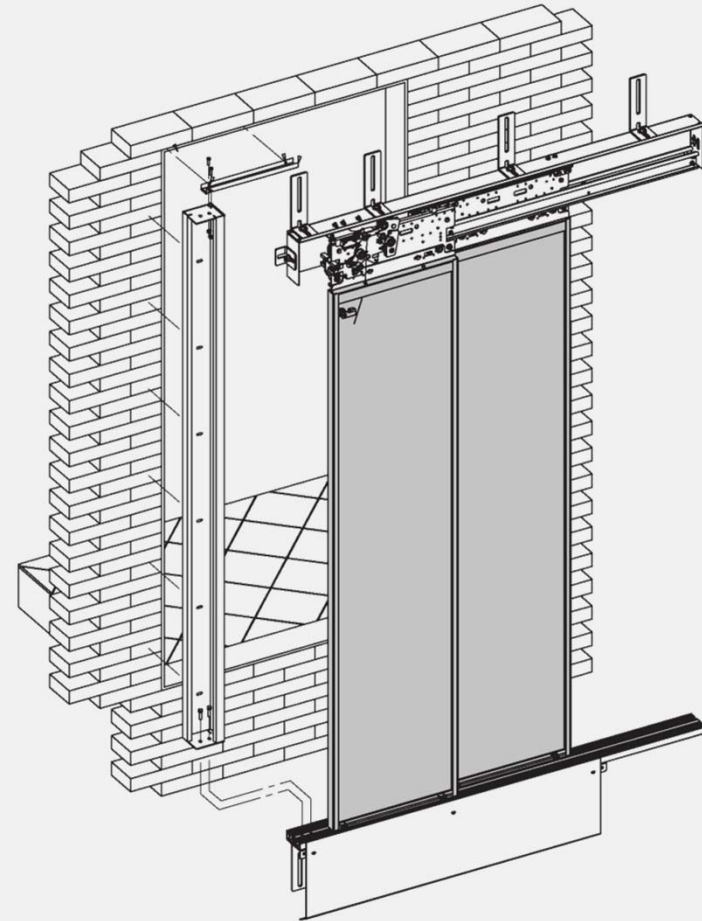

Required construction works and predispositions

Electrical panel

The electrical panel has the following dimensions:

- height: 2100 mm
- width: 500 mm
- depth: 250 mm

The electrical panel shall be positioned on a door side of the upper landing floor. The position is important because the technicians, in case of maintenance activities or emergency cases, have to control the machine looking into the shaft. The machine position is hardly recognizable from the bottom landing floor or, anyway, from a position under the platform level. Possible particular requests from the Customer have to be discussed with the Technical dpt. in order to check the feasibility and guarantee the safety of the technicians.

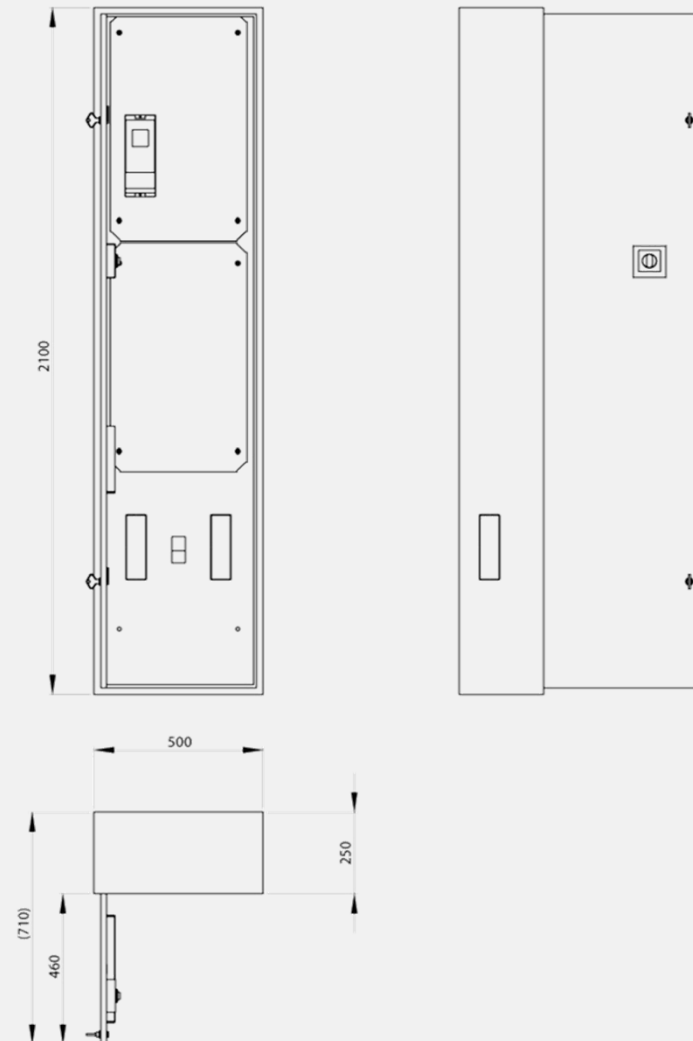

Required construction works and predispositions

Electrical connections

The electrical connections from the shaft to the electrical panel are possible simply realizing two holes on the side of the upper landing floor where the electrical panel is positioned.

Position and dimensions of the necessary holes are related to the electrical panel position and available on the specific order drawing.

Considering a standard configuration, have the following features:

- dimensions: \varnothing 60 mm;
- position: 200 mm and 400 mm from the floor, 40 mm from the lateral wall.

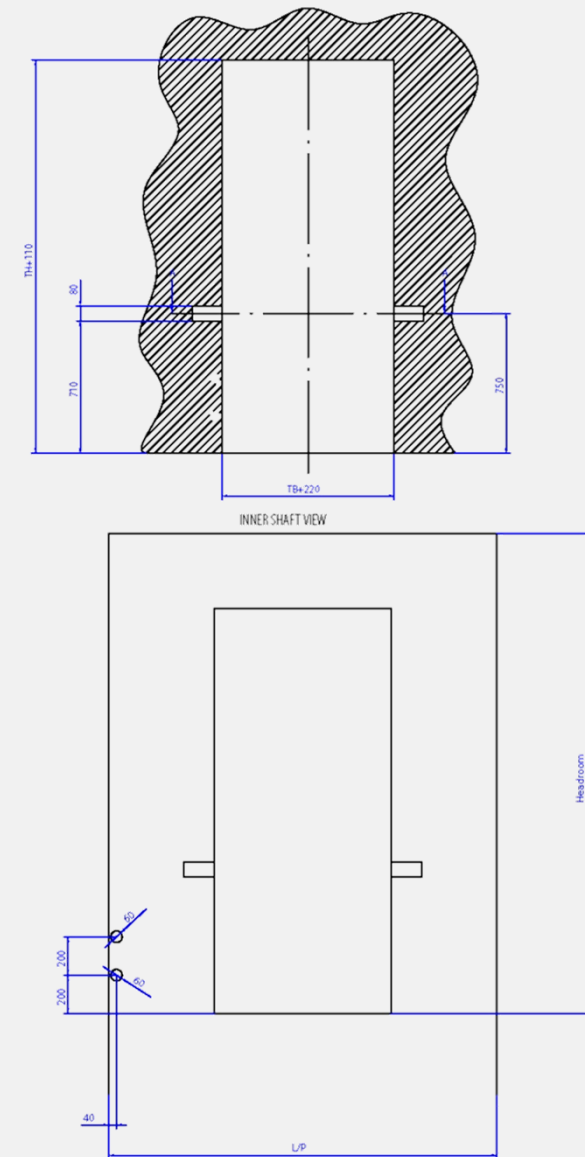

Installation and maintenance activities

Installation and maintenance activities

Table of contents

- Installation phases
-

- Safety rules
-



Installation and maintenance activities

Installation phases

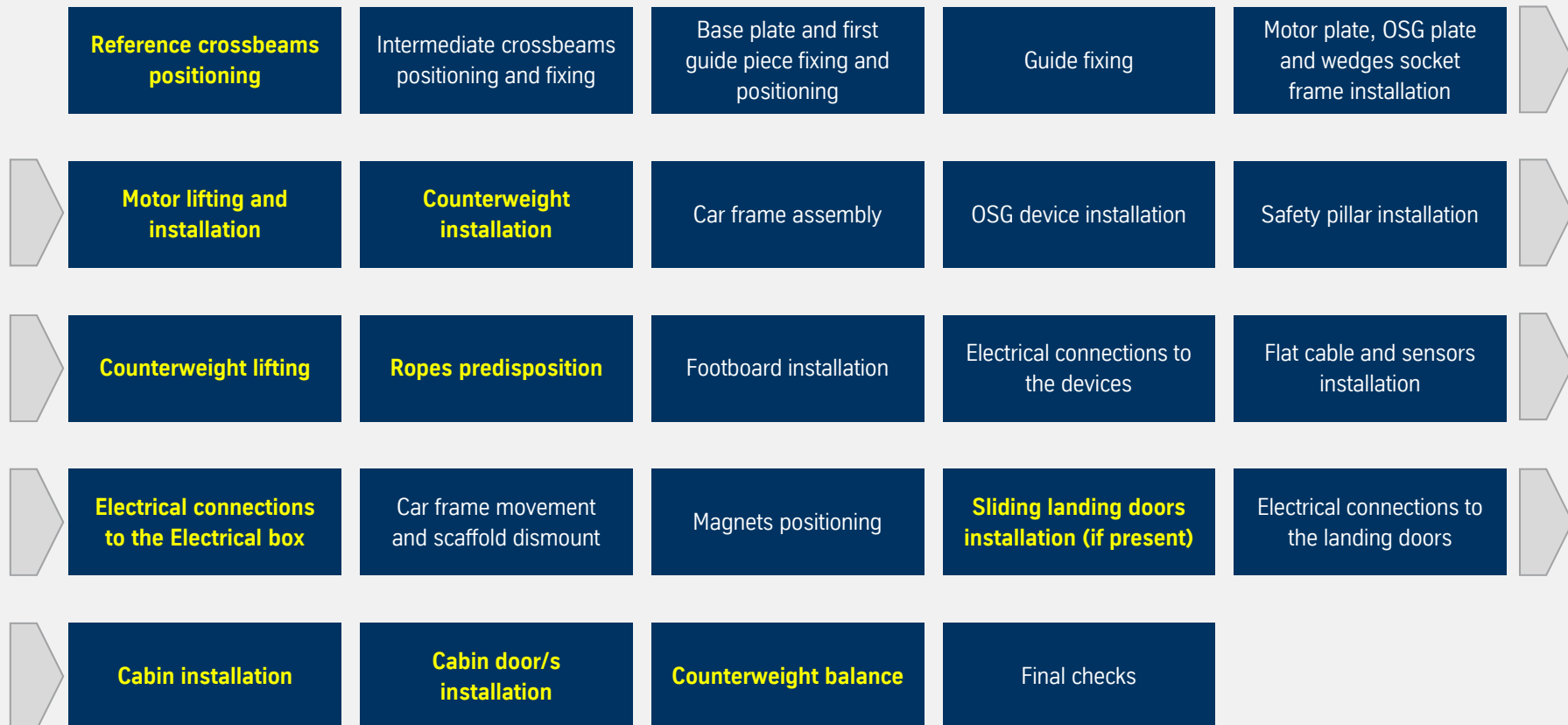

Installation and maintenance activities

Safety rules

Individual safety devices and the general warning indications are listed at the beginning of the phases. Those equipments and general safety rules are very important to guarantee the technicians safety during the installation. Furthermore specific safety indications basing on the risks analysis performed are available where needed.

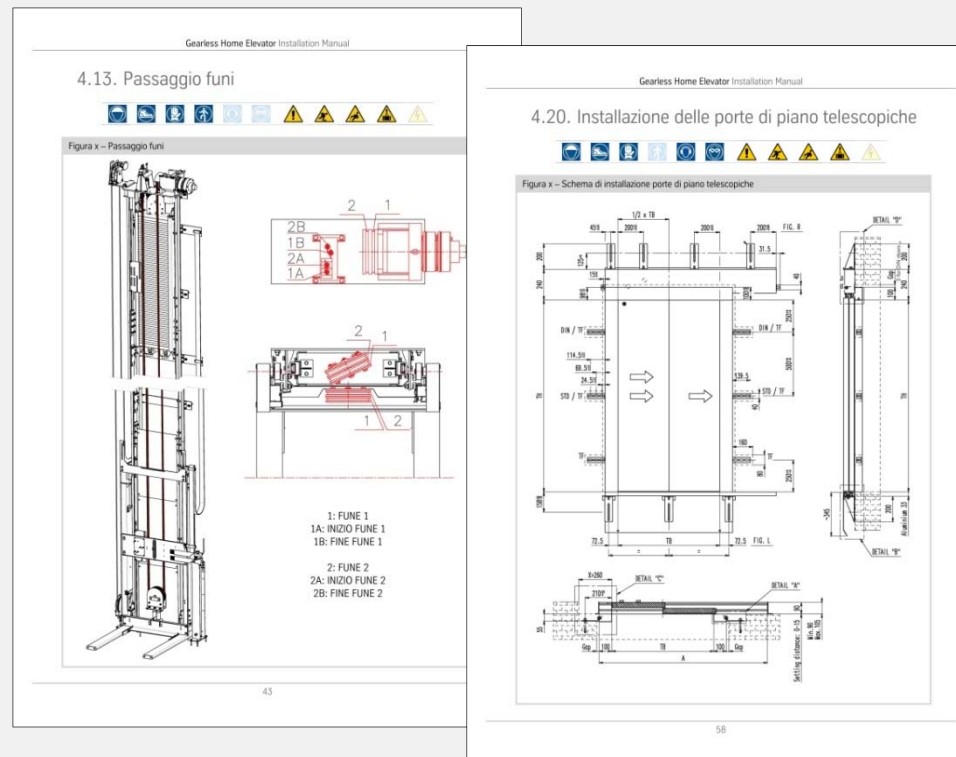

Marketing material

Pricing and marketing material

Marketing material

Key visual



Appears in all relevant communication channels

Translates the idea of „Welcome home.“ (home elevator is considered as integral and intimate part of the home – comparable even with a bathroom).

It creates attention due to untypical setting.

Pricing and marketing material

Marketing material

Print catalogues



Pricing and marketing material

Marketing material

Technical specifications

Home Elevators 6-series, 7-series

Technical Specifications

ThyssenKrupp Encasa
Life in motion.

5

Cabin Dimensions
The cabin minimum dimensions (width x depth) in relation to the access/es configuration are:

- > Frontal access: 1090 mm x 860 mm
- > Lateral access: 1120 mm x 890 mm
- > Opposite access: 1140 mm x 860 mm
- > Adjacent access: 1120 mm x 860 mm

The maximum dimensions are to be considered in relation to the plan configuration; further details are available on the commercial documentation. In general, the cabin dimensions are definable considering the following formulas:

- > Frontal access – Sliding cabin door/s and sliding landing door:
width = shaft width: 120 mm (metal shaft: 200 mm)
depth = shaft depth: 680 mm (metal shaft: 676 mm)
- > Lateral access – Sliding cabin door/s and sliding landing door:
width = shaft width: 276 mm (metal shaft: 356 mm)
depth = shaft depth: 406 mm (metal shaft: 620 mm)
- > Opposite access – Sliding cabin door/s and sliding landing door:
width = shaft width: 430 mm (metal shaft: 610 mm)
depth = shaft depth: 406 mm (metal shaft: 620 mm)
- > Adjacent access – Sliding cabin door/s and sliding landing door:
width = shaft width: 276 mm (metal shaft: 356 mm)
depth = shaft depth: 580 mm (metal shaft: 676 mm)
- > Frontal access – Sliding cabin door/s and hinged landing door:
width = shaft width: 120 mm (metal shaft: 200 mm)
depth = shaft depth: 470 mm (metal shaft: 666 mm)
- > Lateral access – Sliding cabin door/s and hinged landing door:
width = shaft width: 186 mm (metal shaft: 286 mm)
depth = shaft depth: 406 mm (metal shaft: 620 mm)

The maximum dimensions are to be considered in relation to the plan configuration; further details are available on the commercial documentation. In general, the cabin dimensions are definable considering the following formulas:

- > G
d
w
d
- > A
d
w
d
- The
The
- Cab
Cabi
> ai
d
al
al
- Cabi
> P
> R

Cabin Layout 7-series

"Noble" configuration
Cabin wall made of veneered wood with decorative surface and raised mouldings, dark oak or dark walnut essences.
Cabin floor made of solid wood with decorative surface and central inlay.
Cabin operating panel made of same material of the wall panel.
Cabin ceiling made of same material of the wall panel. 4 spot lights with gold effect ring (diameter: 110mm).
Handrail in stainless steel gold finishing, diameter 40 mm.

"Ronanisi" configuration
Cabin wall made of white veneered wood with raised mouldings in the lower part and textile wallpaper in the upper part.
Cabin floor made of vinyl (printed pattern wood light oak, thickness 2,6 mm).
Cabin operating panel made of same material of the wall panel.
Cabin ceiling made of white varnished wood with raised moulding on the perimeter. Embedded light spot glass.
Handrail in stainless steel gold finishing, diameter 40 mm.

"Cool" configuration
Cabin wall made of veneered wood with s steel inlays, dark ebony or dark oak essences.
Cabin floor made of marble girt (traskalid 630).
Cabin operating panel made of same material of the wall panel.
Cabin ceiling made of a glass panel.
Handrail in stainless steel polished finishing, diameter 40 mm.

Electrical Safety Features
UPS system for the machine operation in case of power outage, electro-mechanical blocking system should even ropes broken, over-speed governor against descent acceleration, double brake on the gearless motor, lock with safety switch for door closure and approach control, electro-mechanical limit switch, metal structure earth connection, 24 Vdc auxiliary electrical system.

Door Floor Levelling
Floor levelling operates automatically at the smallest displacement, in order to keep the platform in floor aligned with the landing floor.

Mechanical Safety Features
Instantaneous grip safety stop, double lifting ropes, overload system, automatic descent to the ground floor, door opening via safety keys.

Speed
0,16 m/s with ascending/descending acceleration ramp in the start and stop phases controlled by inverter.

Rated Load
400 kg

Type Approval
CE, TÜV

Regulation Compliance
Machine Directive 2006/42/CE

Contents
Modules to assemble on site with bolt connections, 24 months guarantee, compliance declaration (in accordance with stipulations in Machine Directive 2006/42/CE)

Customer Responsibilities
Necessary building works and modifications, connection of electricity lines from the building, establishment to the machine control panel, telephone line connections in accordance with existing legislation, enclosure guarantee for the interface between the building and the platform lift (shaft walls).

7

Soft Drive Technology

Smart Installation

Tailormade Design

Environmindful Engineering

ThyssenKrupp Encasa
ThyssenKrupp Area 1, 45148 Essen
Teléfono 0130 777
www.thyssenkrupp-elevator.de info@th-thyssenkrupp.de

Pricing and marketing material

Marketing material

Print Ad

Print ad 1/1 A4

Welcome home.

Feel at home: with the Home Elevator HE7 from ThyssenKrupp Encasa. Thanks to the five design options: Cool, Noble, Natural, Romantic and Opulent, you can find an elevator that perfectly matches your own style - while remaining a quiet oasis on every level.

Give us a call: 071 0 777

www.thyssenkrupp.com
info@thyssenkrupp.com

ThyssenKrupp Encasa
Life in motion.

ThyssenKrupp

Print ad 1/2 A4

Welcome home.

Feel at home: with the Home Elevator HE7 from ThyssenKrupp Encasa. Thanks to the five design options: Cool, Noble, Natural, Romantic and Opulent, you can find an elevator that perfectly matches your own style - while remaining a quiet oasis on every level.

Give us a call: 071 0 777

www.thyssenkrupp.com
info@thyssenkrupp.com

ThyssenKrupp Encasa
Life in motion.

ThyssenKrupp

Print ad 1/2 A4

Welcome home.

Feel at home: with the Home Elevator HE7 from ThyssenKrupp Encasa. Thanks to the five design options: Cool, Noble, Natural, Romantic and Opulent, you can find an elevator that perfectly matches your own style - while remaining a quiet oasis on every level.

Give us a call: 071 0 777

www.thyssenkrupp.com
info@thyssenkrupp.com

ThyssenKrupp Encasa
Life in motion.

ThyssenKrupp

Print ad 1/1 A5

Welcome home.

Feel at home: with the Home Elevator HE7 from ThyssenKrupp Encasa. Thanks to the five design options: Cool, Noble, Natural, Romantic and Opulent, you can find an elevator that perfectly matches your own style - while remaining a quiet oasis on every level.

Give us a call: 071 0 777

www.thyssenkrupp.com
info@thyssenkrupp.com

ThyssenKrupp Encasa
Life in motion.

ThyssenKrupp

Pricing and marketing material

Marketing material

Website

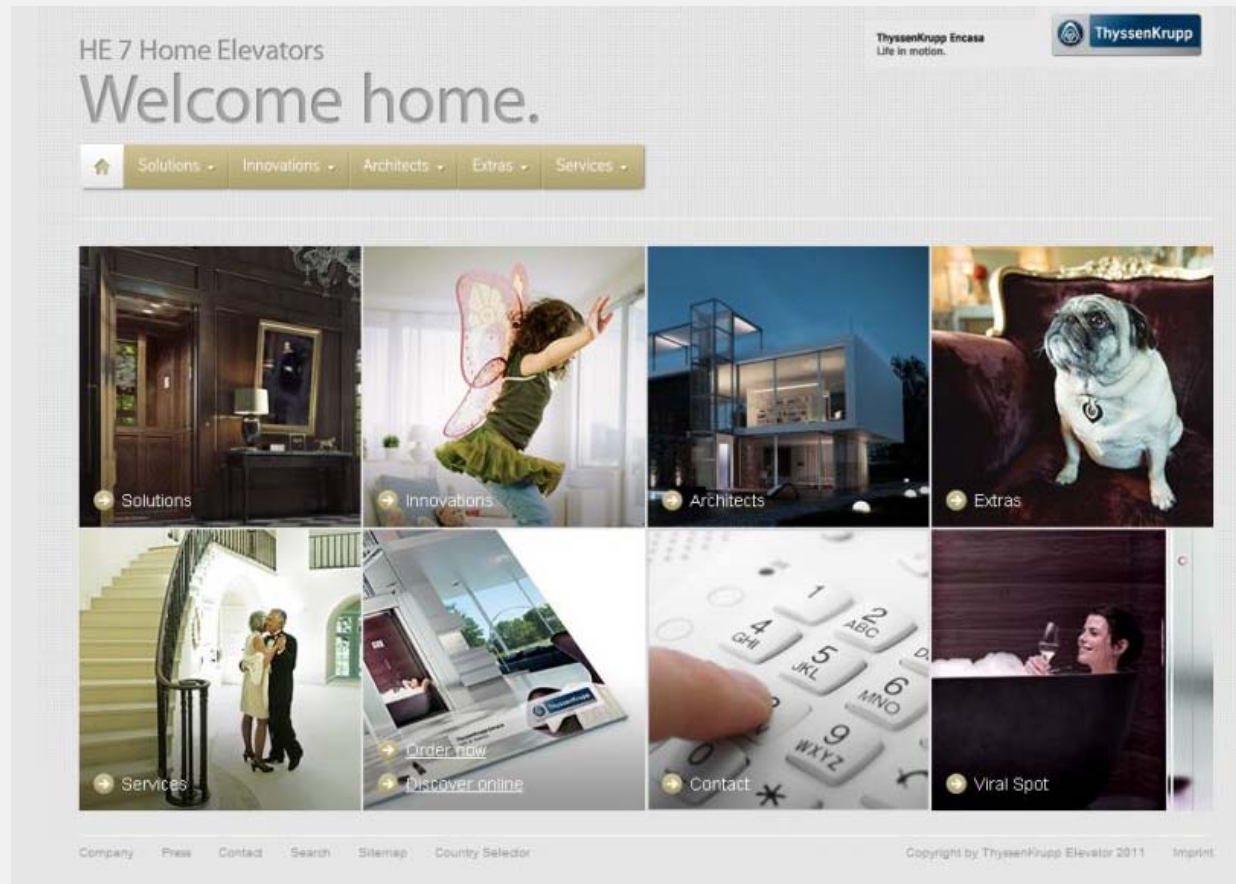

Pricing and marketing material

Marketing material

Online banner

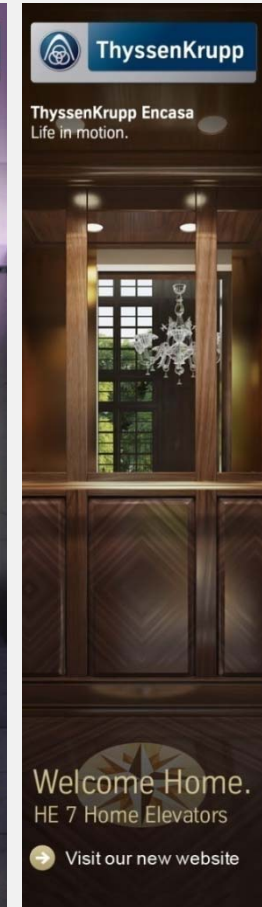

Pricing and marketing material

Marketing material

Viral spot



Thank you for your attention!

